

PHILIPS

sonicare

Sonic electric
toothbrush with app

DiamondClean
Smart

Personalised coaching

Smart brush head sensors

Smart brush head recognition

4 modes, 3 intensities

HX9901/14



Our best ever electric toothbrush, for complete oral care

Feel confident, with 100% coverage

The DiamondClean Smart is our best toothbrush, for complete care. Four high-performance brush heads let you focus on all areas of your oral health, and our Smart Sensor technology gives you personalised feedback and coaching.

Proven to improve oral health

- Remove up to 100% more stains** in just 3 days

Personalised in-app coaching to perfect brushing

- Guides your brushing and highlights missed areas
- Takes you back to any missed spots for 100% coverage
- Start taking better care of your trouble areas
- Alerts you if you're pressing too hard
- Guides you to reduce your scrubbing

Optimise your brushing

- Make sure you're getting the most from your brush head
- Brush heads automatically select the optimal settings
- Choose from 4 modes and 3 intensity settings

Highlights

Whiter teeth, fast



Click on the W3 Premium White brush head to remove surface stains and reveal your whitest smile. With its densely packed central stain removal bristles, it's clinically proven to remove up to 100% more stains in just three days.**

Never miss a spot

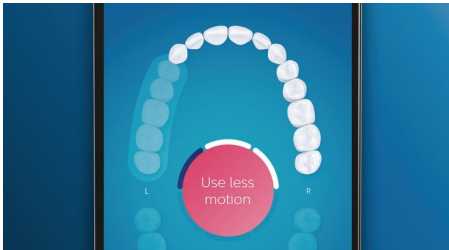

The Philips Sonicare app lets you know when you've achieved a thorough clean and coaches you to be a better, more mindful brusher.

TouchUp feature

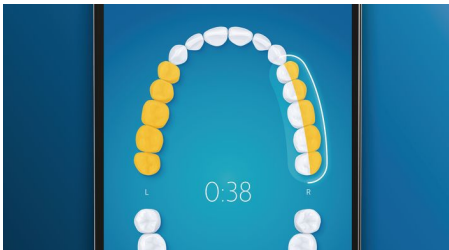

If you happen to miss a spot while brushing your teeth, your app's TouchUp feature will show you. You can then go back for a second pass, and be confident you are getting a complete clean, every time.

Smart replacement reminders

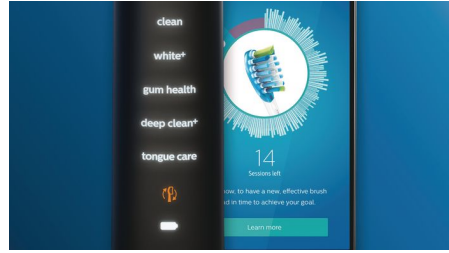

Brush heads wear out over time and become less effective at removing plaque. With smart brush head recognition you'll never lose track of when to replace your brush head. Your toothbrush tracks how long and hard you've brushed with each brush head, and will alert you when it's time to replace. You can also monitor the lifetime of your brush heads in the Philips Sonicare app, and even order replacements so you're never caught short.

Focus areas and goal-setting

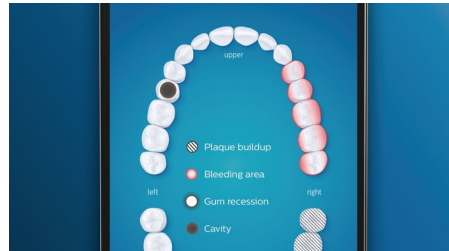

Any trouble areas your dentist has pointed out? We'll highlight them on your in-app 3D mouth map and remind you to pay extra attention to these areas.

Too much pressure?

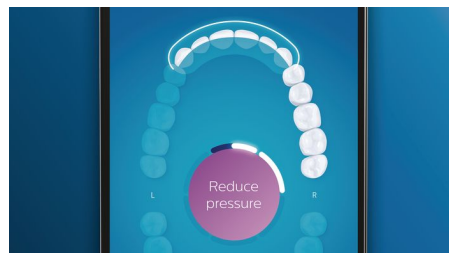

You might not notice when you brush too hard, but your DiamondClean Smart will. If you use too much pressure, the light ring on the end of your handle will flash. This is a gentle reminder to ease off the pressure and let your brush head do the work. 7 out of 10 people found that this feature helped them to become a better brusher.

Easy does it



With an electric toothbrush, you let the brush do the work. We've built a scrubbing sensor into your handle as a gentle reminder to reduce scrubbing. This way, you can improve your technique and get a gentler, more effective clean.

BrushSync mode pairing

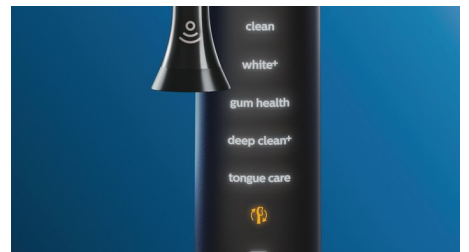

Wondering which mode and intensity you should use? Wonder no longer. A microchip in your brush head tells your DiamondClean Smart which one you're using. So if you click on a gum-care brush head, for example, your toothbrush knows to select the optimal mode and intensity to provide gentle yet effective care for your gums. All you need to do is to press the power button.

4 modes, 3 intensity settings

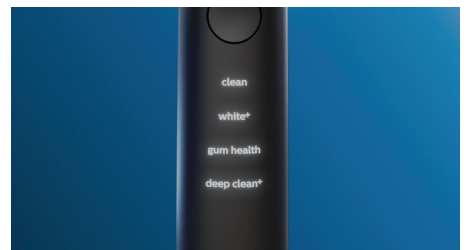

With DiamondClean Smart you get the full works. Our 3 intensity settings let you boost your clean and our 4 modes cover all your brushing needs; Clean mode for exceptional daily cleaning, White+ to remove stains, Deep Clean+ for an invigorating deep clean, and Gum Health to gently clean along your gum line.

Specifications

Modes

Clean: For exceptional everyday cleaning

Deep Clean+: For an invigorating deep clean

Gum Health: Special attention to molars

White+: To remove surface stains

3 intensities: Low, Medium, High

Items included

Handle: 1 DiamondClean Smart

Brush heads: 1 W3 Premium White

Glass charger: 1

Charger base: 1

BrushSync Mode Pairing

C3 Premium Plaque Control: Pairs with Clean mode

G3 Premium Gum Care brush head: Pairs with Gum Health mode

W3 Premium White brush head: Pairs with White+ mode

Connectivity

Bluetooth® wireless technology: Connected brushing app

Compatibility

Android compatibility: Android phones, Bluetooth 4.0-enabled tablets

iOS compatibility: iPad 3rd Gen or higher, iPhone 4S or higher, with iOS7 or higher

Design and finishing

Colour: Black

Cleaning performance

Speed: Up to 62,000 brush movements/min

Health benefits: Helps improve gum health

Pressure feedback: Ring lights up in purple, Vibrates handle to alert user

TouchUp: Ensures 100% coverage

Timer: BrushPacer and SmarTimer

Whitening benefits: Removes 100% more stains*

Smart sensor technology

Pressure sensor: Alerts when brushing too hard

Location sensor: Tracks and improves coverage

Scrubbing sensor: Guides to reduce scrubbing

3D mouth map: Highlights trouble areas

TouchUp: To address missed spots

Ease of use

Handle compatibility: Easy click-on brush heads

Brush head recognition: Syncs with optimal mode

Replacement reminder: To always ensure best results, reminder icon lights up

Battery indicator: Illuminated icon indicates battery life

Handle: Slim ergonomic design

Display: Illuminated display

Technical specifications

Battery: Rechargeable

Battery type: Lithium ION

Operating time (full to empty): 14 days*****

Power

Voltage: 110-220 V

Service

Warranty: 2-year limited warranty



* Removes up to 7x more plaque vs. a manual toothbrush

** as compared to a manual toothbrush with a leading whitening toothpaste

** compared to DiamondClean

**** in Gum Health mode vs a manual toothbrush at 2 weeks

***** after 3 days of use in White+ mode vs a manual toothbrush

***** based on two periods of two-minute brushings per day on standard mode