

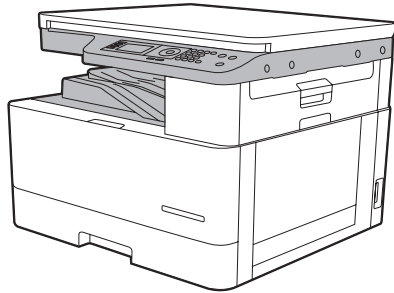

HP LaserJet MFP M433a  
HP LaserJet MFP M436n  
HP LaserJet MFP M436dn  
HP LaserJet MFP M436nda



JC68-03613C01



M433a, M436n, M436dn

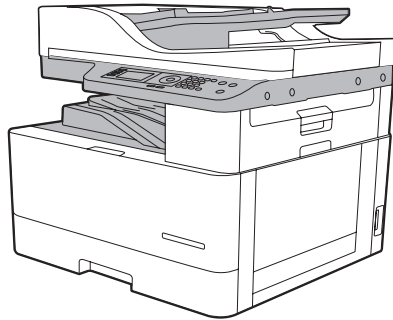

M436nda

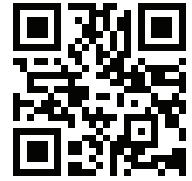

<https://hp.com/videos/a3>

- EN Quick Installation Guide
- FR Guide d'installation rapide
- DE Installations-Kurzanleitung
- IT Guida rapida all'installazione
- ES Guía rápida de instalación
- BG Кратко ръководство за инсталиране
- CN 快速安装指南
- HR Brzi vodič za instalaciju
- CS Stručná instalační příručka
- DA Hurtig installationsvejledning
- NL Korte installatiehandleiding
- FI Pika-asennusopas
- EL Οδηγός γρήγορης εγκατάστασης
- HU Rövid telepítési útmutató
- ID Panduan Penginstalan Cepat
- PL Skrócona instrukcja instalacji
- PT Guia de instalação rápida
- RO Ghid de instalare rapidă
- RU Краткое руководство по установке
- SR Vodič za brzu instalaciju
- SK Rýchly sprievodca inštaláciou
- SL Priročnik za hitro namestitev
- SV Snabb installationsguide
- TH คู่มือการติดตั้งอย่างรวดเร็ว
- TW 快速安装指南
- TR Hızlı Kurulum Kılavuzu
- UK Короткий посібник зі встановлення
- VI Hướng dẫn cài đặt nhanh
- AR دليل التثبيت السريع



support.hp.com

ES Lea esto primero

M436n  
M436dn  
M433a

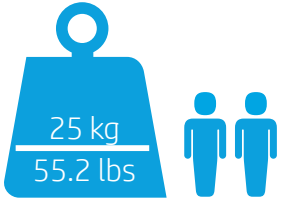
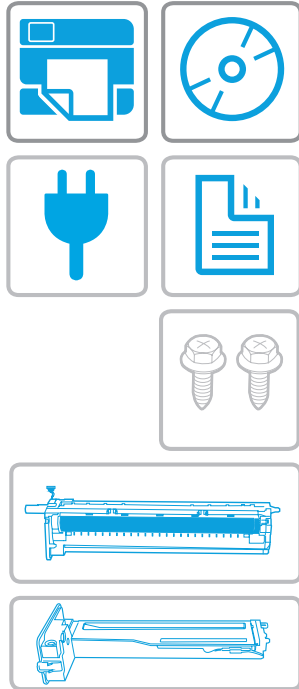
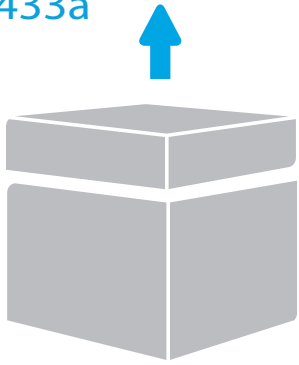

M436nda

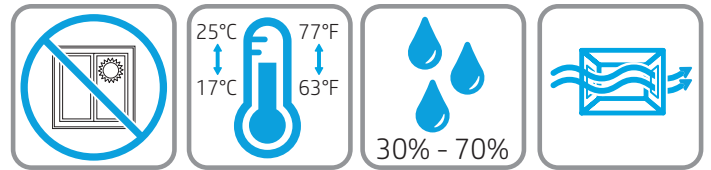
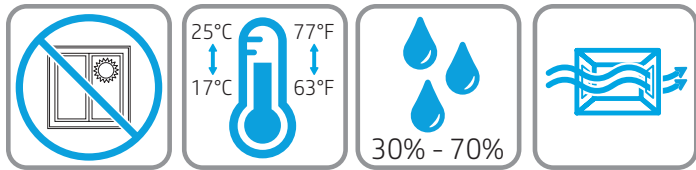
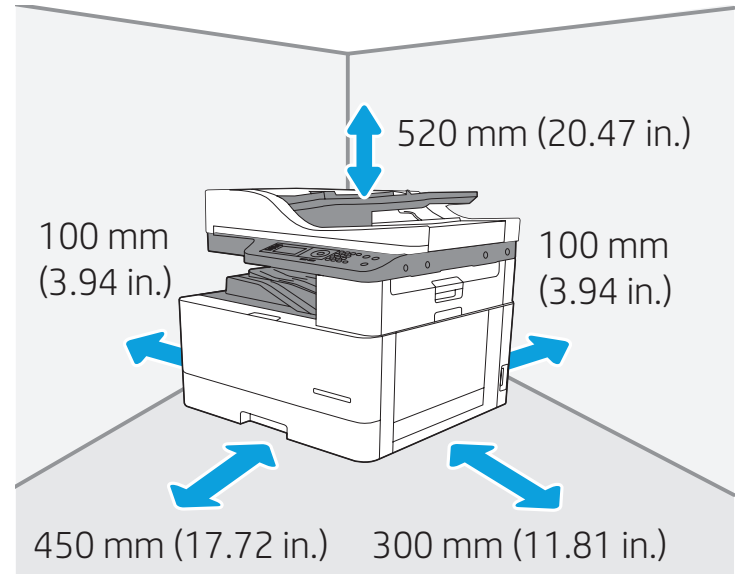
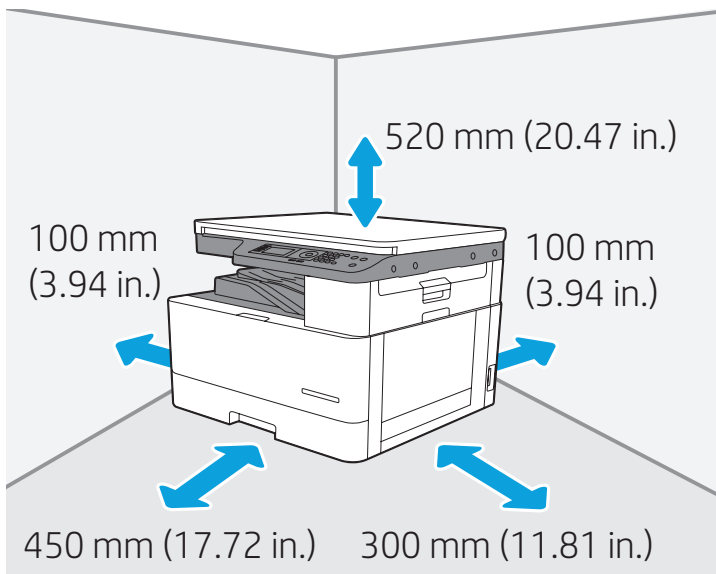
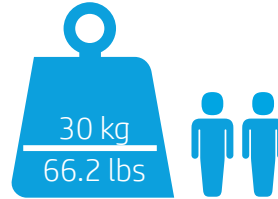
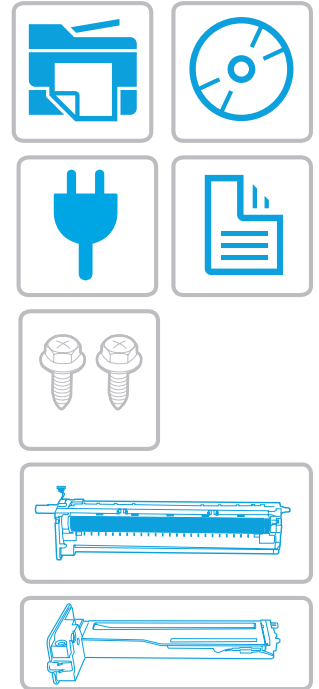
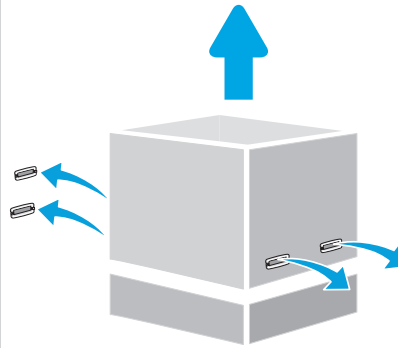

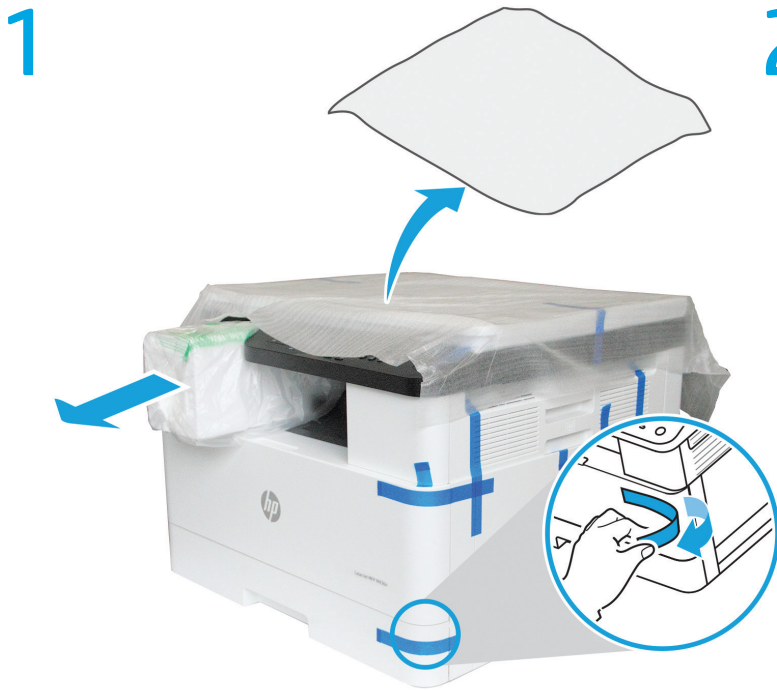

7

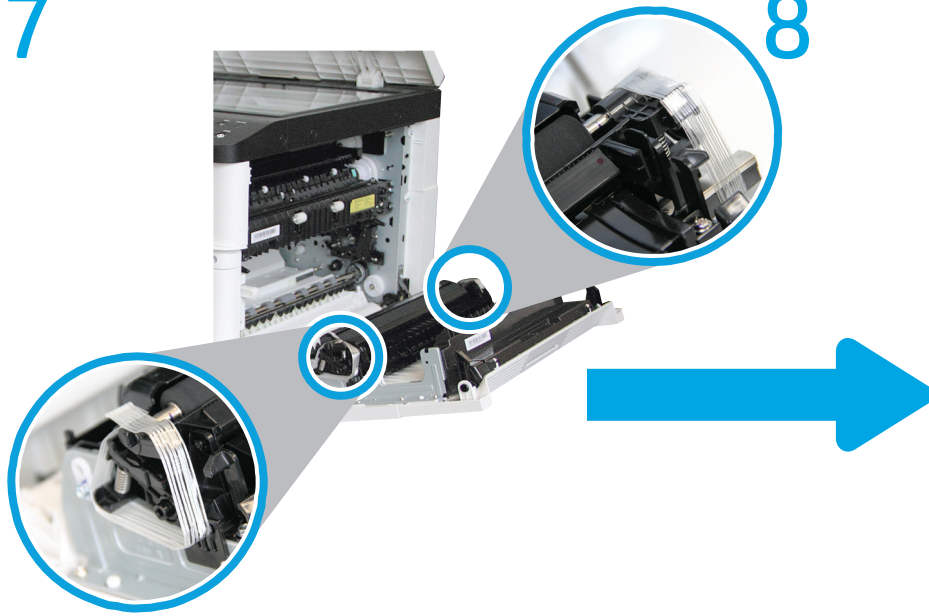

8

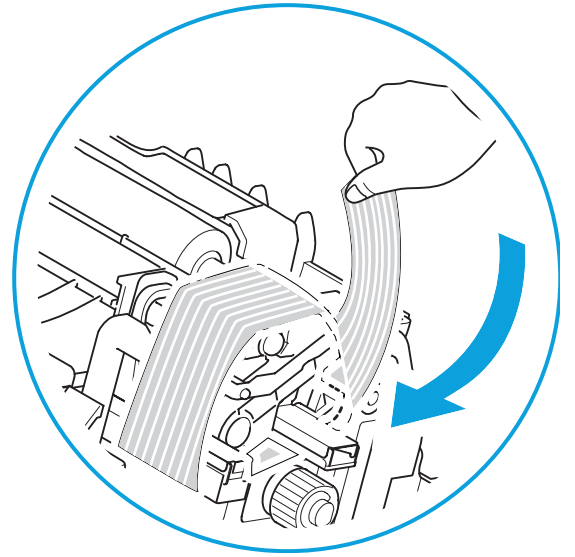

9

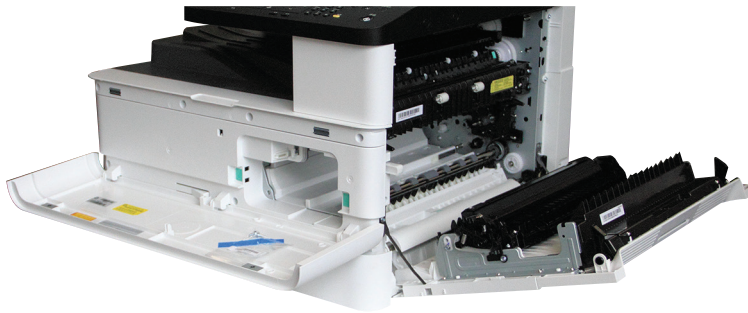

10



11



12

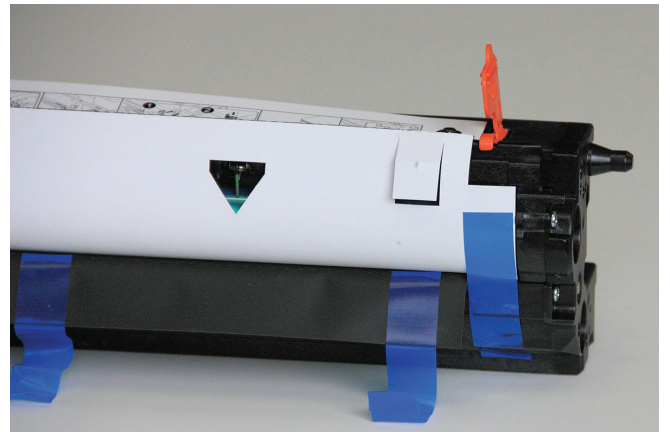

13

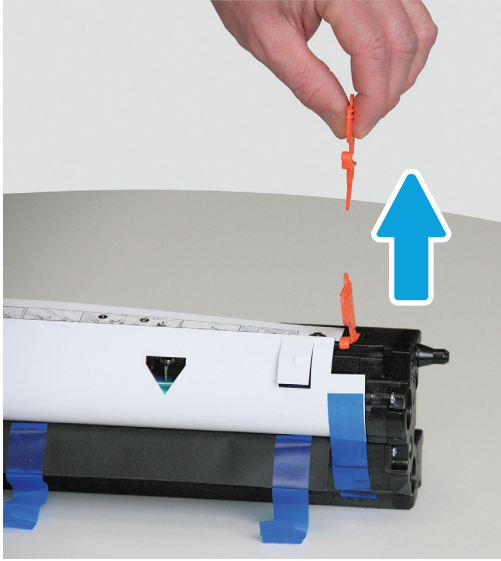

14

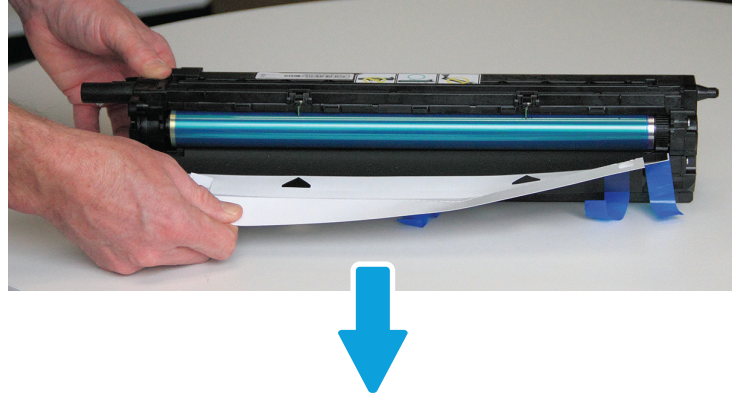

15



16



17



18

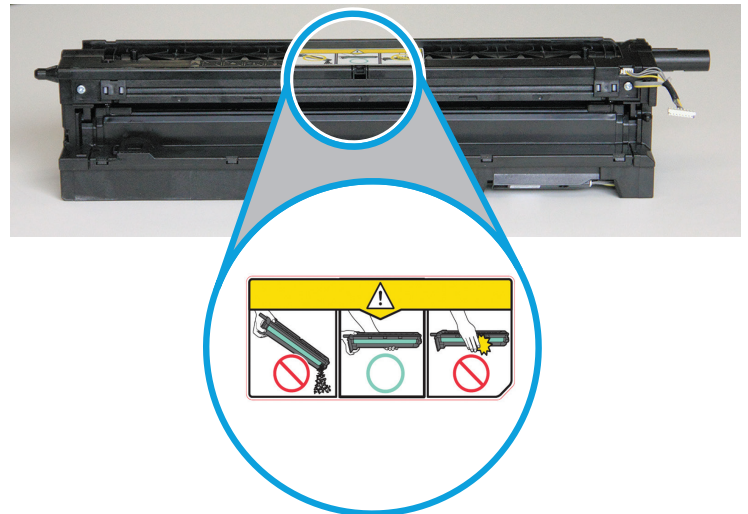

19

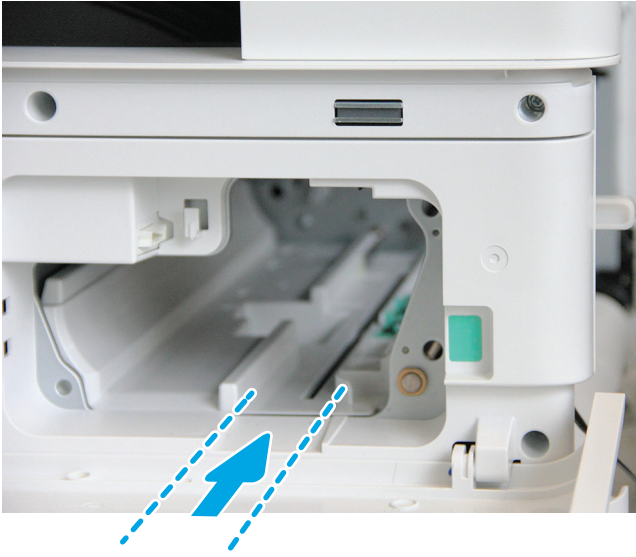

20

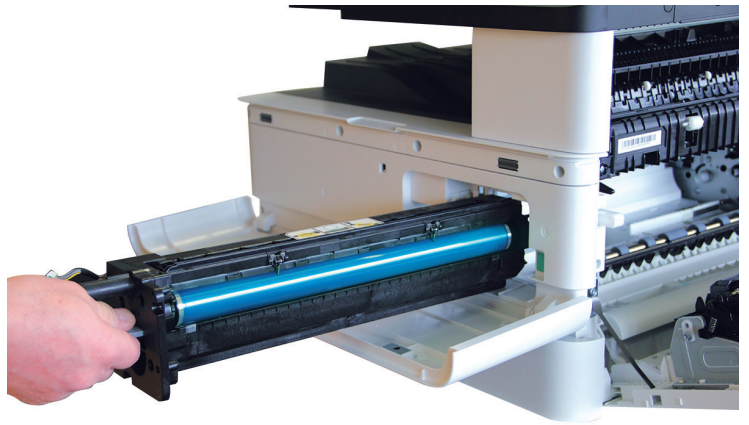

21

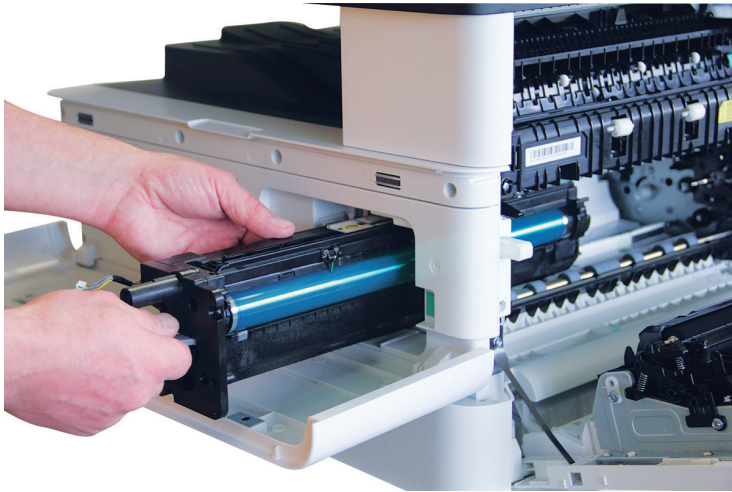

22

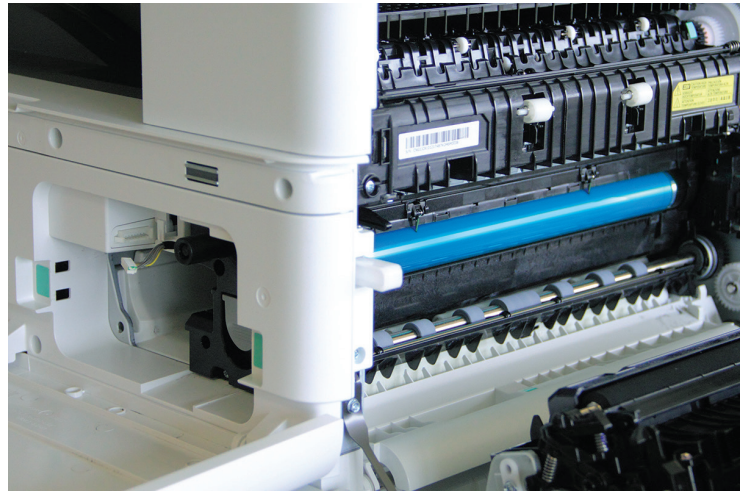

23

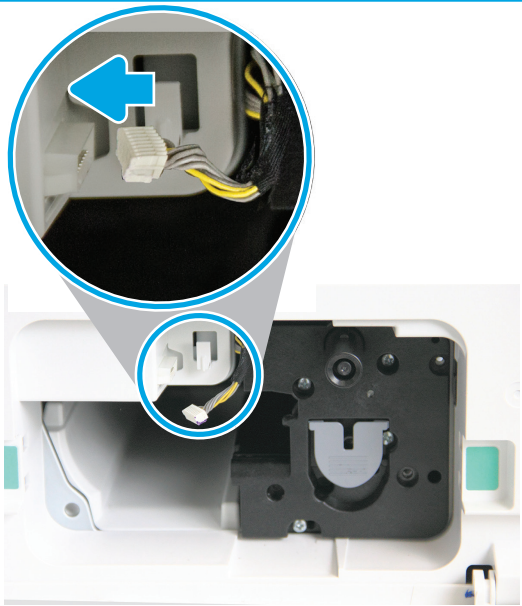

24

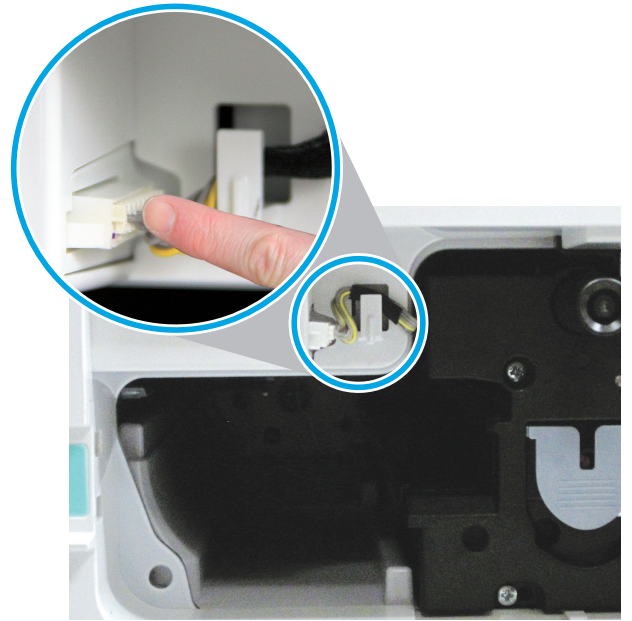

25

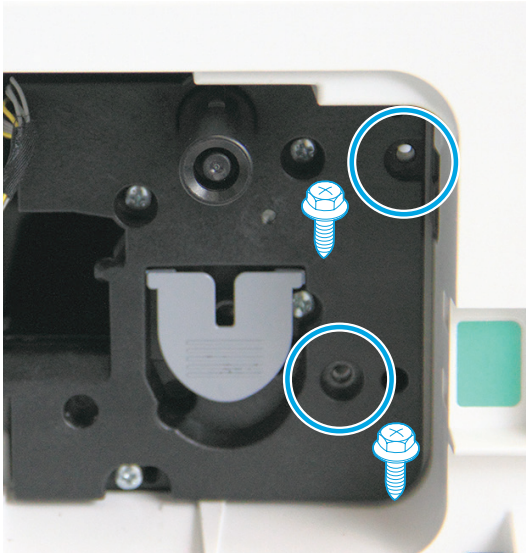
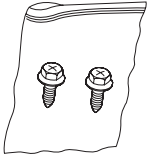

26

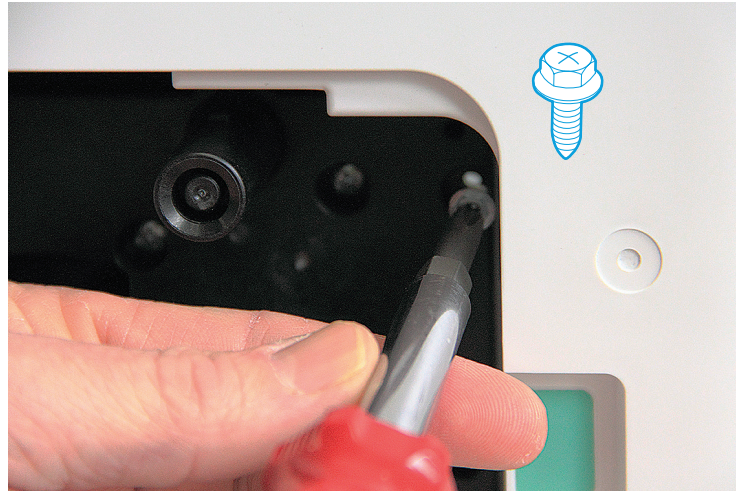

27

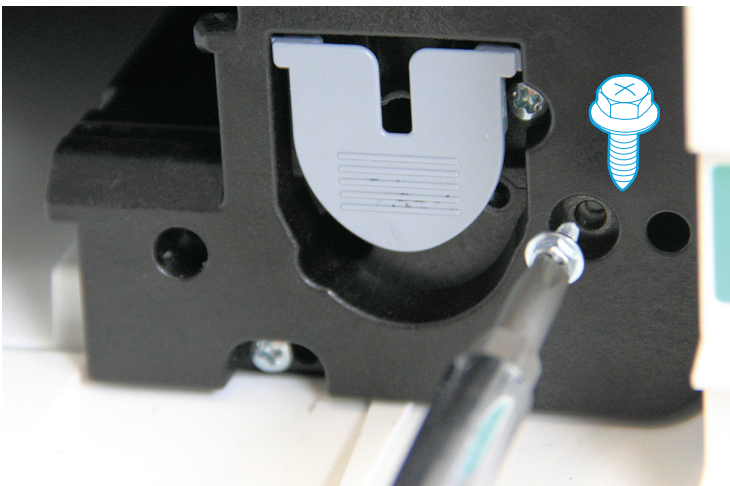

28

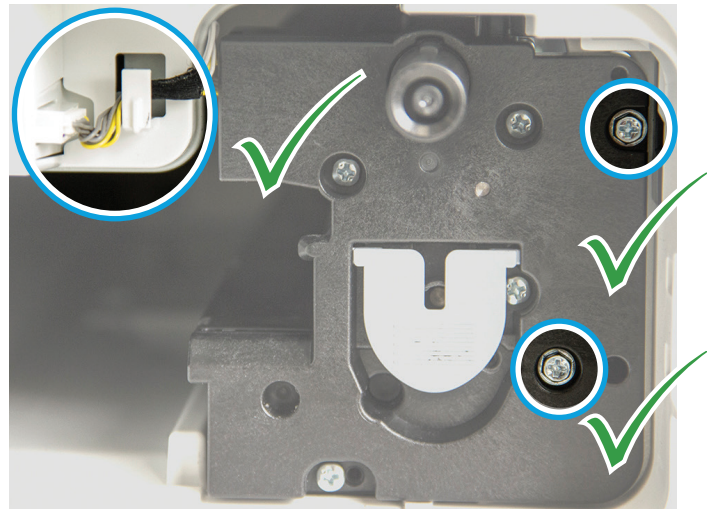

29



30

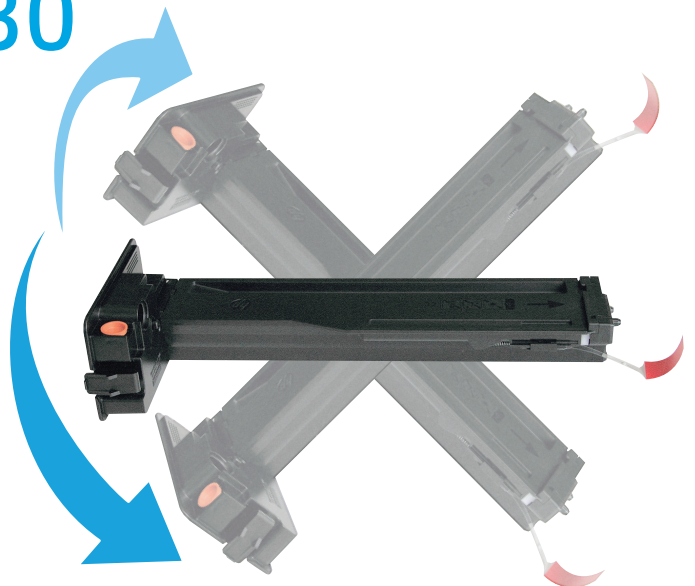

31

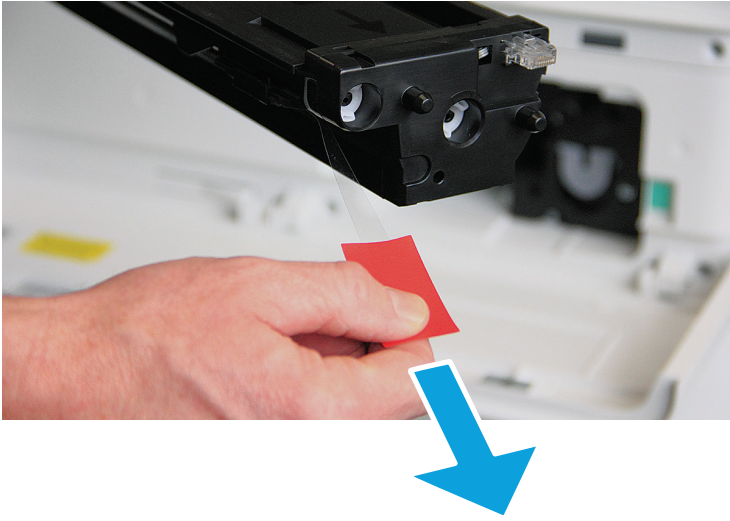

32



33



34



35



36





37



38



39

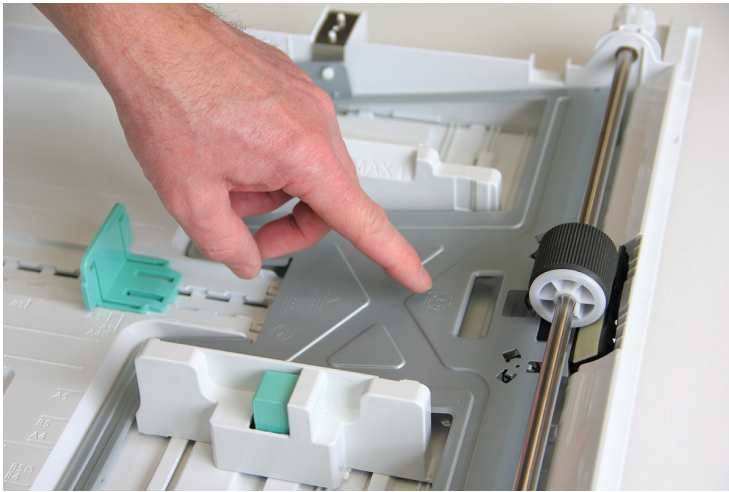

40

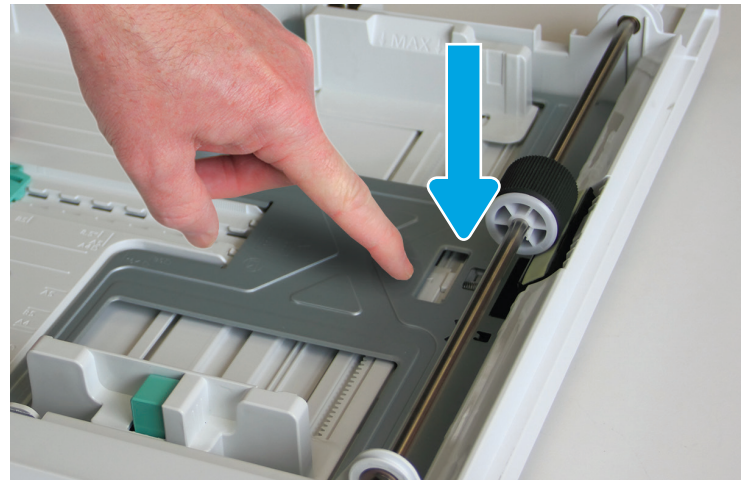

41

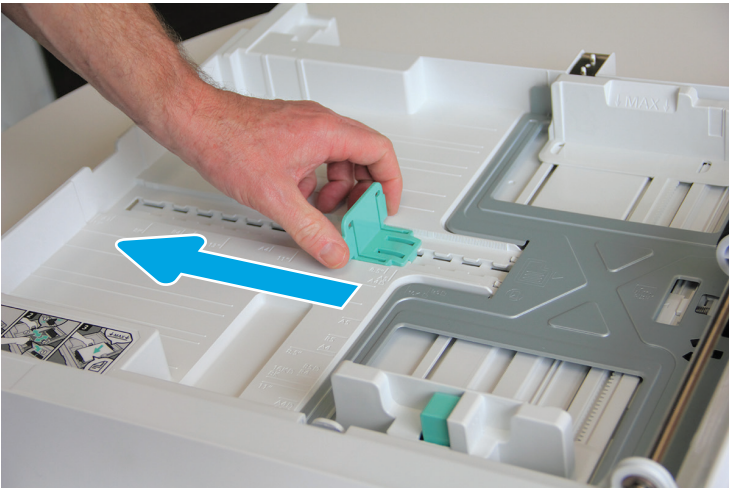

42

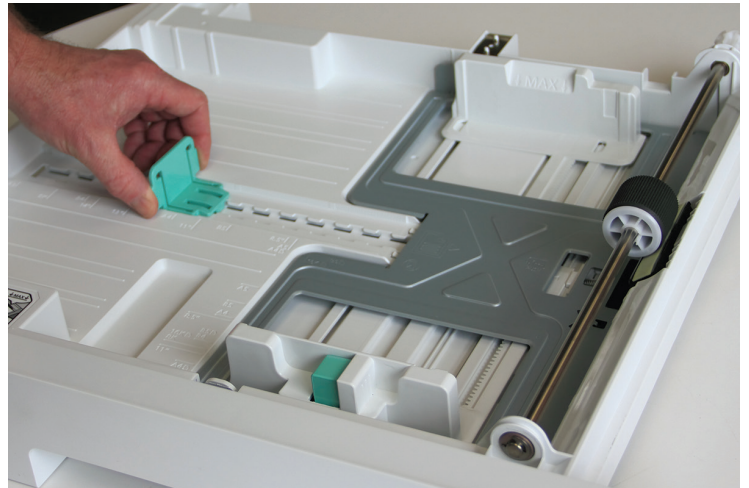

43

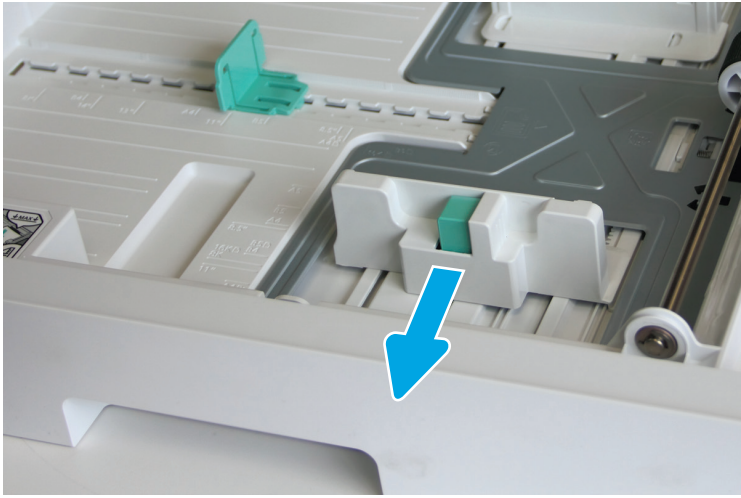

44



45

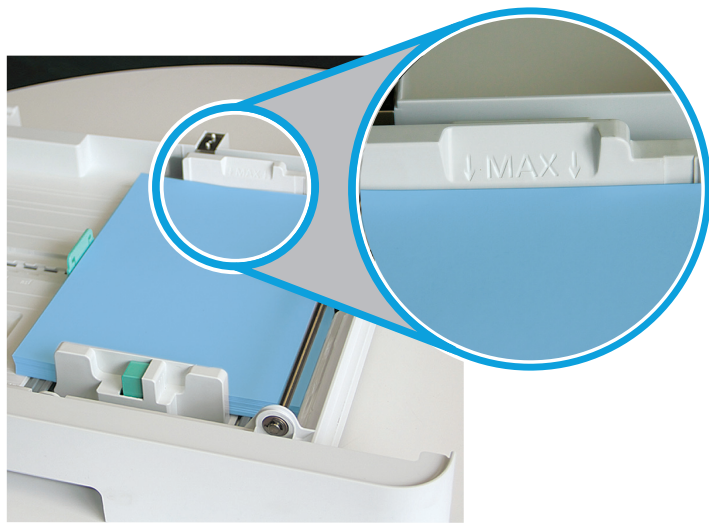

46

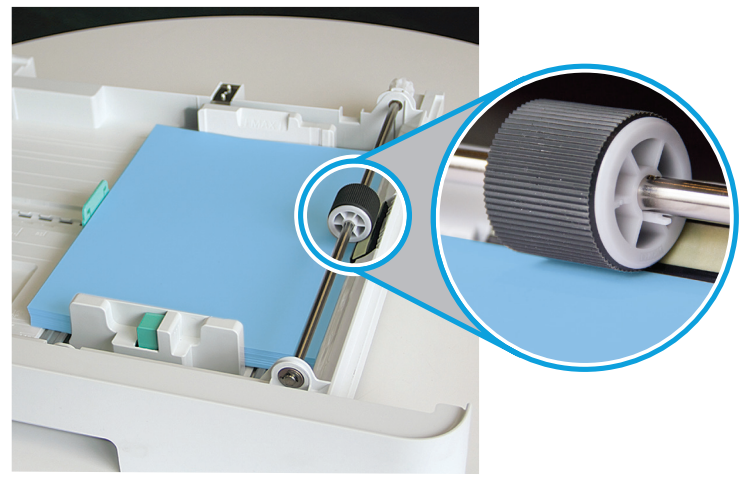

47



48



49



50

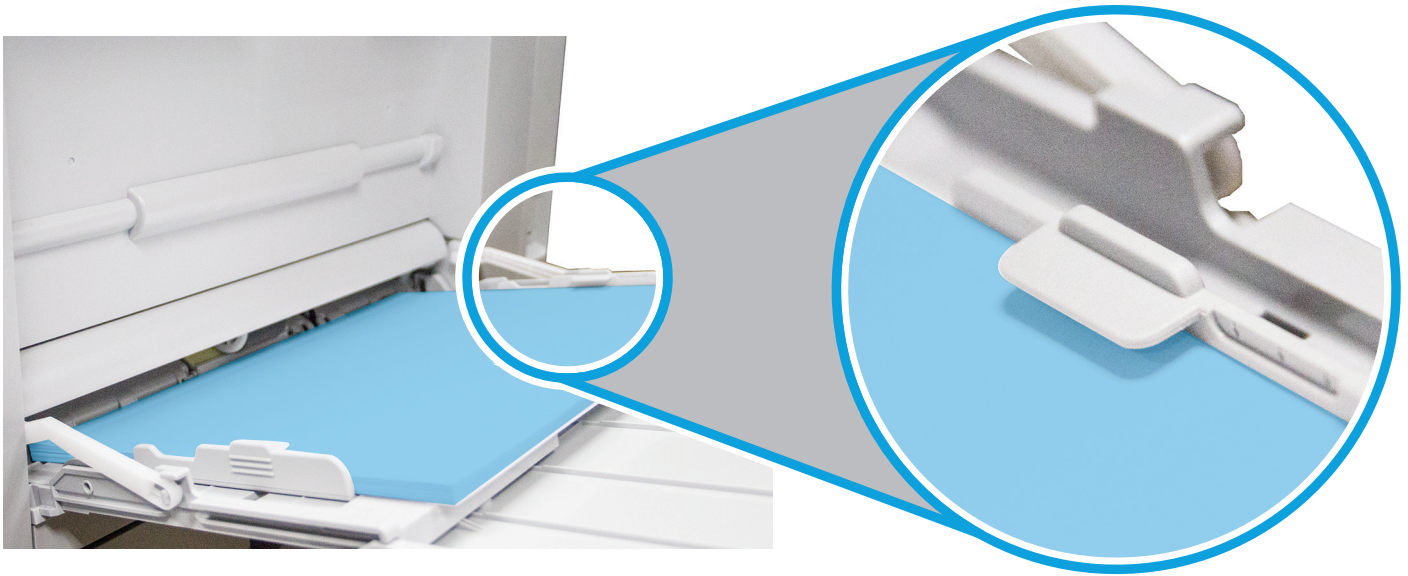

51

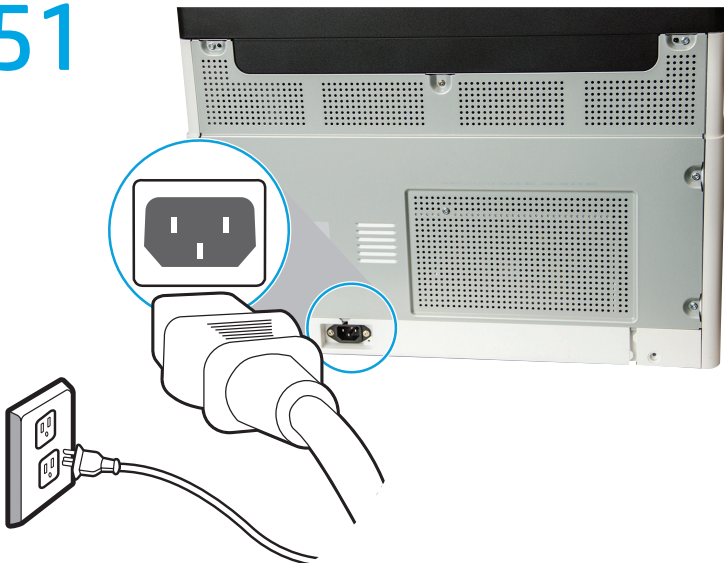

52





- EN** To install the print drivers, follow the on-screen instructions. The user guide is located on the CD.
- FR** Pour installer les pilotes d'impression, suivez les instructions à l'écran. Le guide de l'utilisateur se trouve sur le CD.
- DE** Um die Druckertreiber zu installieren, folgen Sie den auf dem Bildschirm angezeigten Anweisungen. Das Benutzerhandbuch befindet sich auf der CD.
- IT** Per installare i driver di stampa, seguire le istruzioni visualizzate sullo schermo. La guida per l'utente è disponibile sul CD.
- ES** Para instalar los controladores de impresión, siga las instrucciones que aparecen en pantalla. La guía del usuario se encuentra en el CD.
- BG** За да инсталирате драйверите за печат, следвайте инструкциите на екрана. Ръководството за потребителя се намира на компактдиска.
- CN** 要安装打印驱动程序，请按屏幕上的说明进行操作。用户指南位于 CD 上。
- HR** Kako biste instalirali upravljačke programe za pisač, slijedite upute na zaslonu. Korisnički priručnik nalazi se na CD-u.
- CS** Při instalaci ovladačů tiskárny postupujte podle pokynů na obrazovce. Uživatelská příručka je umístěna na disku CD.
- DA** Hvis du vil installere printerdriverne, skal du følge vejledningen på skærmen. Brugervejledningen findes på cd'en.
- NL** Volg de instructies op het scherm om de printerstuurprogramma's te installeren. U kunt de gebruikershandleiding op de cd vinden.
- FI** Asenna tulostinohjaimet noudattamalla näytön ohjeita. Käyttöopas on CD-levyllä.
- EL** Για να εγκαταστήσετε τα προγράμματα οδήγησης εκτύπωσης, ακολουθήστε τις οδηγίες στην οθόνη. Ο οδηγός χρήσης βρίσκεται στο CD.
- HU** A nyomtató-illesztőprogramok telepítéséhez kövesse a képernyőn megjelenő utasításokat. A felhasználói útmutató a CD-n található.
- ID** Untuk menginstal driver printer, ikuti petunjuk di layar. Panduan pengguna ada di CD.
- PL** Aby zainstalować sterowniki druku, wykonaj instrukcje widoczne na ekranie. Podręcznik użytkownika można znaleźć na płycie CD.
- PT** Para instalar os drivers de impressão, siga as instruções na tela. O guia do usuário está localizado no CD.
- RO** Pentru a instala driverule de imprimare, urmați instrucțiunile de pe ecran. Ghidul utilizatorului se găsește pe CD.
- RU** Чтобы установить драйверы принтера, следуйте инструкциям на экране. Руководство пользователя содержится на компакт-диске.
- SR** Da biste instalirali upravljačke programe štampača, pratite uputstva na ekranu. Uputstvo za upotrebu se nalazi na CD-u.
- SK** Ak chcete nainštalovať tlačové ovládače, postupujte podľa zobrazených pokynov. Používateľská príručka sa nachádza na disku CD.
- SL** Za namestitev gonilnikov tiskalnika sledite navodilom na zaslonu. Uporabniški priročnik je na CD-ju.
- SV** För installation av skrivardrutinerna, följ instruktionerna på skärmen. Användarhandboken finns på CD-skivan.
- TH** ในการติดตั้งไดรเวอร์การพิมพ์ให้ทำตามคำแนะนำบนหน้าจอ คู่มือผู้ใช้มีอยู่ในแผ่นซีดี
- TW** 若要安裝列印驅動程式，請依照螢幕上的指示進行。使用者指南位於 CD 上。
- TR** Yazdırma sürücülerini kurmak için ekrandaki talimatları izleyin. Kullanıcı kılavuzu CD'de yer alır.
- UK** Щоб встановити драйвери друку, дотримуйтеся вказівок на екрані. Посібник користувача є на компакт-диску.
- VI** Để cài đặt các trình điều khiển in, hãy làm theo các hướng dẫn trên màn hình. Hướng dẫn sử dụng nằm trên đĩa CD.
- AR** لتثبيت برامج تشغيل الطباعة، اتبع الإرشادات التي تظهر على الشاشة. دليل المستخدم موجود على القرص المضغوط CD.



W7U02-90912

Printed in China  
Imprimé en Chine  
中国印刷

© Copyright 2018 HP Development Company, L.P.

