



# The pinnacle of performance and security

## HP LaserJet Enterprise M607, M608, M609 series



The world's most  
secure printing<sup>1</sup>



High-speed  
performance



Powerful printing.  
Energy smart.<sup>2</sup>

# The world's most secure printing<sup>1</sup>



Only HP enterprise printers repair themselves from attacks in real time while offering outstanding manageability. Automatically monitor threats, detect intrusions, and validate operating software while centrally managing your fleet with ease.



## Always on guard

Only HP Enterprise printers offer built-in security features that are always on guard.<sup>1</sup>

- With HP Sure Start, each printer regularly checks its operating code and repairs itself from attempted hacks.
- Whitelisting checks firmware during startup to help ensure its authentic, good code—digitally signed by HP.
- Run-time intrusion detection continually monitors activity to detect and stop attacks, then automatically reboots.
- HP Connection Inspector inspects outgoing network connections to stop suspicious requests like malware.

Get instant notification of potential security issues so immediate action can be taken to prevent potential attacks. This printer works with leading Security Information and Event Management (SIEM) tools like Splunk, ArcSight, and McAfee.



## Take security to the next level

Help protect your printer with more than 100 embedded security features.<sup>3</sup> Protect information on the printer and in transit over the network. Store data on the optional 256-bit encrypted HP High-Performance Secure Hard Disk.

Add features such as card readers<sup>4</sup> and more through the Hardware Integration Pocket.<sup>5</sup> Equip your printer to store and protect larger files with the optional 1 GB memory upgrade. Further safeguard data stored on the printer—keys, passwords, certificates, and more—using the optional HP Trusted Platform Module.<sup>6</sup>

Easily develop, deploy, and integrate over 180 HP and third-party solutions with the HP Open Extensibility Platform. Optional HP Access Control solutions can help you reinforce security, while helping to reduce costs.



## Centralise control to help build business efficiency

Centralise control of your printing environment with HP Web Jetadmin.<sup>7</sup> Optional HP JetAdvantage Security Manager offers an effective, policy-based approach to help secure HP devices.<sup>8</sup> Easily set security configuration policies and automatically validate settings across the fleet.

HP JetAdvantage Secure Print<sup>9</sup> and HP Access Control (HPAC) help secure documents by requiring authentication to release print jobs. In addition, extend capabilities and easily customise with HPAC—integrate job accounting, manage rights, and establish quotas for things such as colour use. Save IT time and make printing easy for the entire enterprise by using a single driver for all HP devices.

### ► For more information

#### Fleet management

HP Web Jetadmin visit: [hp.com/go/wja](http://hp.com/go/wja)

Solution brief: <http://h20195.www2.hp.com/v2/GetPDF.aspx/4aa5-2719eew.pdf>

Video: <http://hp.brightcovegallery.com/solutions/detail/video/4271055504001/>

HP Universal Print Driver visit: [hp.com/go/upd](http://hp.com/go/upd)

Solution brief: <http://h20195.www2.hp.com/v2/GetPDF.aspx/4aa2-4781eew.pdf>

#### Security

HP JetAdvantage Security Solutions visit: [hp.com/go/printsecurity](http://hp.com/go/printsecurity)

Solution overview: <http://h20195.www2.hp.com/v2/GetPDF.aspx/4aa3-1295eew.pdf>

Video: <http://hp.brightcovegallery.com/products/detail/video/4270905124001/>

HP JetAdvantage Security Manager visit: [hp.com/go/securitymanager](http://hp.com/go/securitymanager)

Brochure: <http://h20195.www2.hp.com/v2/GetPDF.aspx/4aa3-9275eew.pdf>

Video: <http://hp.brightcovegallery.com/products/detail/video/4270837770001/>

# High-speed performance

Get the job done with a printer equipped for high-speed performance and designed for energy efficiency. Be confident that your employees can speed through their tasks without interruption.

## Keep business moving

Don't wait for documents—this printer prints your first page from ready/sleep mode as fast as 5.1/7.9 seconds.<sup>10,11</sup> Get prints up to 71 pages per minute (ppm),<sup>12</sup> A4 (M609 series), with 85% duplex efficiency.<sup>13</sup> Print on A5 paper in landscape mode at speeds up to 115 ppm (M609 series).<sup>14</sup>



Print directly from your smartphone, tablet, or notebook PC to your Wi-Fi Direct®<sup>15</sup>/Bluetooth® Low Energy<sup>16</sup> enabled printer—without accessing the company network. Or choose managed mobile print solutions (HP PrinterOn Enterprise or HP Access Control) for advanced management and reporting capabilities.<sup>17</sup>

## Loaded for productivity

Spend less time loading paper with a 4,400-sheet maximum input capacity.<sup>18</sup> Options for this series include a 2,100-sheet paper feeder, a wheeled stand which helps you relocate the printer, and a 5-bin stapler/stacker/mailbox with job offset. Standard and optional 550-sheet input trays fit a whole ream of paper and support paper sizes from A6 to 216 x 356 mm.



Equip employees to breeze through tasks with the adjustable 10.9 cm touchscreen control panel—available on the HP LaserJet Enterprise M608x and M609x. (For more information, see Appendix A on page 15.) An intuitive 6.9 cm colour graphics display with keypad on the n and dn models makes managing jobs at the printer simple and efficient. An easy-access USB port on all models allows users to easily walk up and print.<sup>19</sup>

## Designed to conserve

Help keep productivity up and energy use down. This efficient printer is designed for exceptionally low energy consumption—thanks to its innovative design and specially formulated toner.<sup>20</sup>



Help cut costs with HP Auto-On/Auto-Off Technology<sup>21</sup> and HP Instant-on Technology<sup>22</sup>—intelligence that readies your printer right when you need it and turns it off when you don't. Support for thin media allows users to print on papers as light as 60 g/m<sup>2</sup>.

# Powerful printing. Energy smart.<sup>2</sup>



Get exceptional print quality and help protect your device, using Original HP Toner cartridges with JetIntelligence.



## Exceptional print quality

Count on the advantages of Original HP Toner cartridges—performance, high quality, and dependability. Precision black toner is engineered to deliver consistent placement of toner particles and produce sharp text, bold blacks, and crisp graphics.



## Help protect your investment

Don't put your printer—and print quality—at risk. Help retain the consistent Original HP quality you paid for with innovative, anti-fraud technology. Enable office-wide adherence to printing policies with cartridge authentication technology.



## Ready to work, right away

Speed through print jobs right out of the box. This printer is shipped with preinstalled, specially designed Original HP LaserJet toner cartridges with JetIntelligence. Auto seal removal enables simple and seamless cartridge replacement, so you can get back to business fast—without costly delays or frustrating messes.



Print uninterrupted and get more pages with optional high-yield and extra-high-yield cartridges<sup>23</sup> (A/X/Y: 11,000/25,000/41,000 pages<sup>24</sup>)

# Get to know the HP LaserJet Enterprise M607 series

HP LaserJet Enterprise M607dn shown

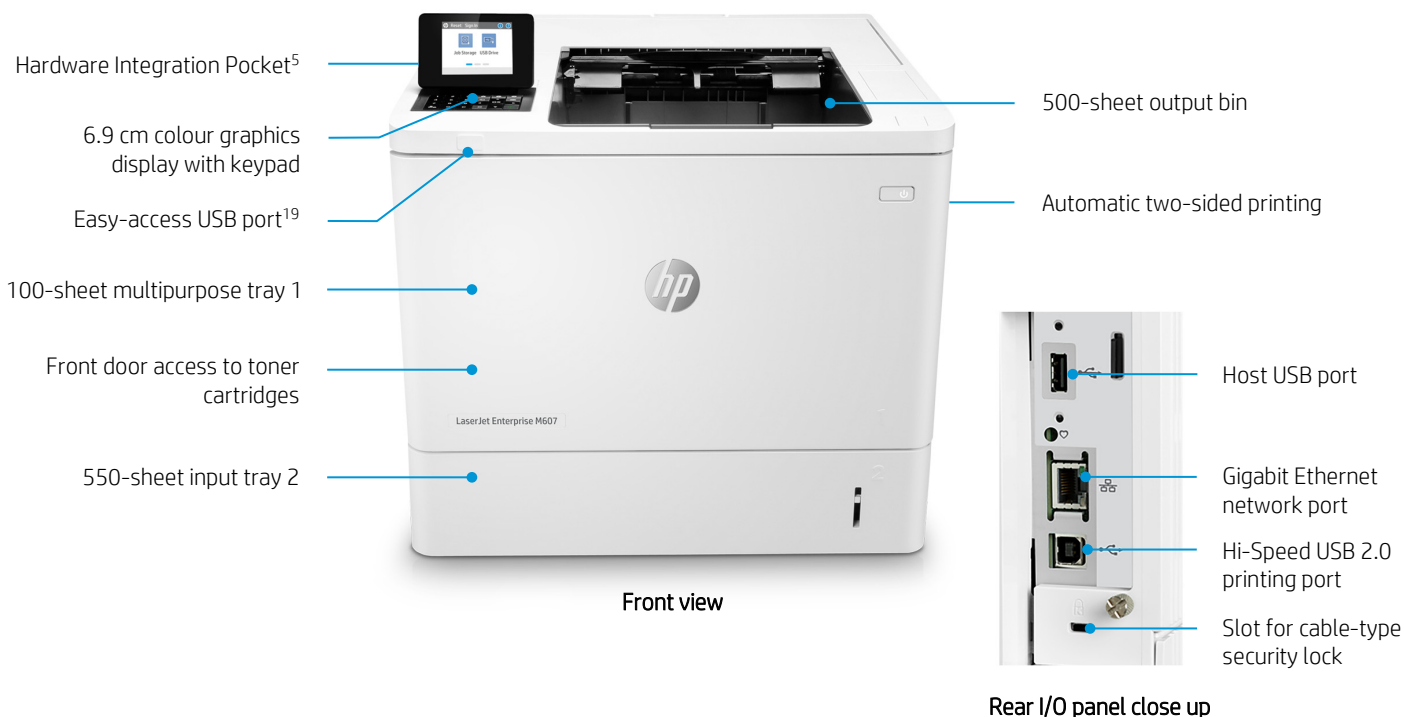

## Series at a glance



Model (product number)	M607n (K0Q14A)	M607dn (K0Q15A)
Print speeds (A4) <sup>12</sup>	Up to 52 ppm	Up to 52 ppm
Control panel	6.9 cm LCD with keypad	6.9 cm LCD with keypad
Automatic two-sided printing	Not available	✓
Hardware Integration Pocket <sup>5</sup>	Not available	✓
100-sheet tray 1 and 550-sheet tray 2	✓	✓
550-sheet paper feeder <sup>25</sup>	Optional (up to four)	Optional (up to four)
2,100-sheet paper feeder <sup>25</sup>	Optional	Optional
Envelope feeder	Optional (up to two)	Optional (up to two)
Printer stand	Optional	Optional
5-bin stapler/stacker/mailbox with job offset	Optional	Optional
Direct mobile printing	Optional wireless direct <sup>15</sup> /NFC <sup>26</sup>	Optional wireless direct <sup>15</sup> /NFC <sup>26</sup>
Wireless networking	Optional <sup>27</sup>	Optional <sup>27</sup>
HP High-Performance Secure Hard Disk	Optional	Optional

# Get to know the HP LaserJet Enterprise M608 series

HP LaserJet Enterprise M608x shown

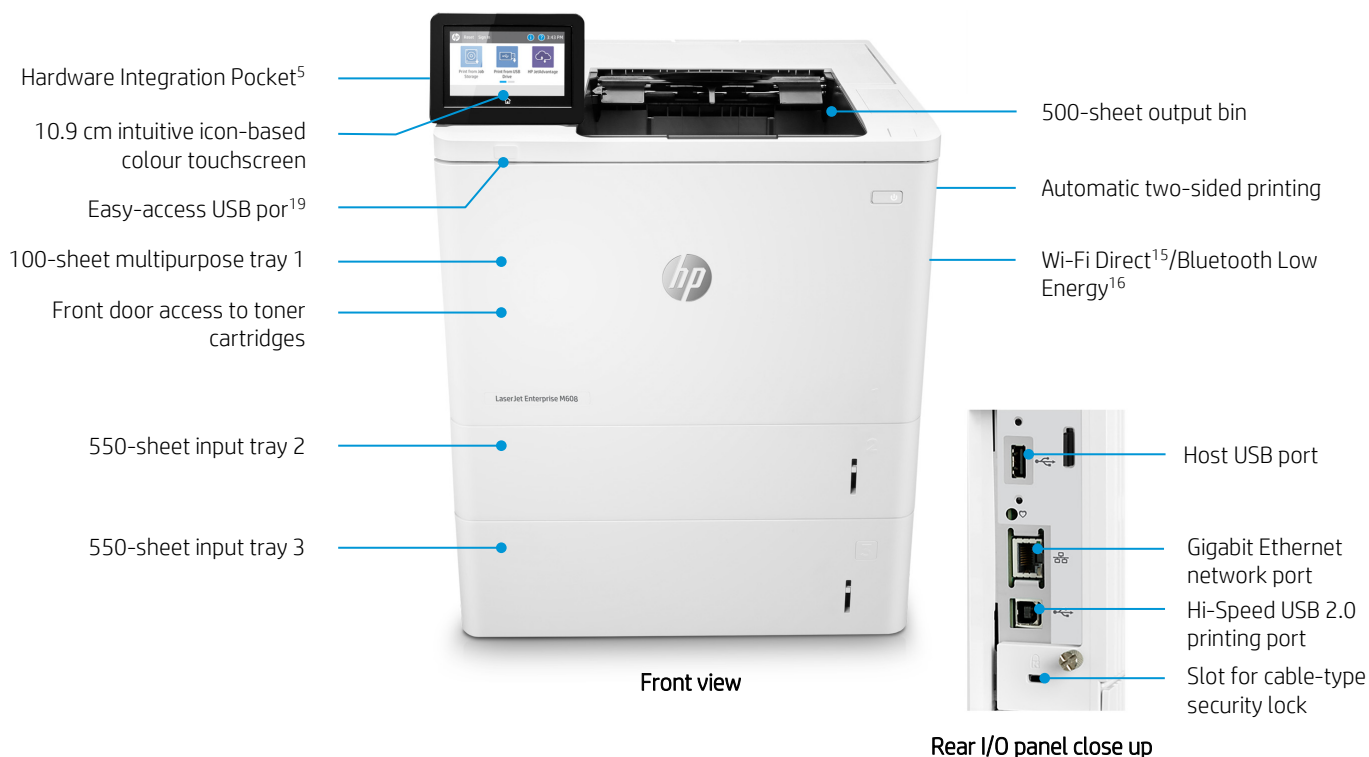

## Series at a glance



Model (product number)	M608n (K0Q17A)	M608dn (K0Q18A)	M608x (K0Q19A)
Print speeds (A4) <sup>12</sup>	Up to 61 ppm	Up to 61 ppm	Up to 61 ppm
Control panel	6.9 cm LCD with keypad	6.9 cm LCD with keypad	10.9 cm colour touchscreen
Automatic two-sided printing	Not available	✓	✓
Hardware Integration Pocket <sup>5</sup>	✓	✓	✓
100-sheet tray 1 and 550-sheet tray 2	✓	✓	✓
550-sheet paper feeder <sup>25</sup>	Optional (up to four)	Optional (up to four)	✓ (plus up to three optional)
2,100-sheet paper feeder <sup>25</sup>	Optional	Optional	Optional
Envelope feeder	Optional (up to two)	Optional (up to two)	Optional (up to two)
Printer stand	Optional	Optional	Optional
5-bin stapler/stacker/mailbox with job offset	Optional	Optional	Optional
Direct mobile printing	Optional wireless direct <sup>15</sup> /NFC <sup>26</sup>	Optional wireless direct <sup>15</sup> /NFC <sup>26</sup>	Embedded Wi-Fi Direct <sup>15</sup> /Bluetooth Low Energy <sup>16</sup>
Wireless networking	Optional <sup>27</sup>	Optional <sup>27</sup>	Embedded <sup>27</sup>
HP High-Performance Secure Hard Disk	Optional	Optional	Optional



# Get to know the HP LaserJet Enterprise M609 series

HP LaserJet Enterprise M609x shown

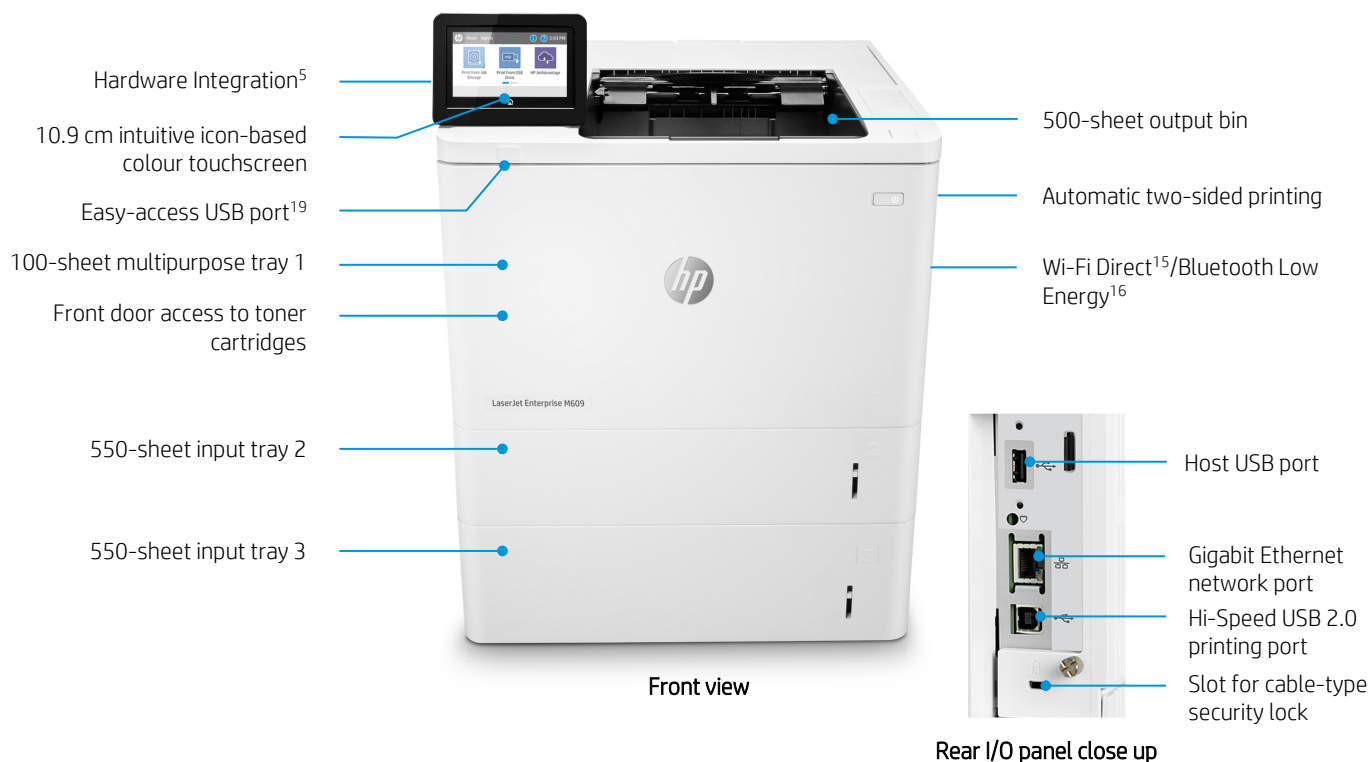

## Series at a glance



Model (product number)	M609dn (K0Q21A)	M609x (K0Q22A)
Print speeds (A4) <sup>12</sup>	Up to 71 ppm	Up to 71 ppm
Control panel	6.9 cm LCD with keypad	10.9 cm colour touchscreen
Automatic two-sided printing	✓	✓
Hardware Integration Pocket <sup>5</sup>	✓	✓
100-sheet tray 1 and 550-sheet tray 2	✓	✓
550-sheet paper feeder <sup>25</sup>	Optional (up to four)	✓ (plus up to three optional)
2,100-sheet paper feeder <sup>25</sup>	Optional	Optional
Envelope feeder	Optional (up to two)	Optional (up to two)
Printer stand	Optional	Optional
5-bin stapler/stacker/mailbox with job offset	Optional	Optional
Direct mobile printing	Optional wireless direct <sup>15</sup> /NFC <sup>26</sup>	Embedded Wi-Fi Direct <sup>15</sup> /Bluetooth Low Energy <sup>16</sup>
Wireless networking	Optional <sup>27</sup>	Embedded <sup>27</sup>
HP High-Performance Secure Hard Disk	Optional	Optional

# Paper-handling accessories



550-sheet paper feeder (LOH17A)



2,100-sheet paper feeder (LOH18A)



Envelope feeder (LOH21A)



Printer stand (LOH19A)



Stapler/stacker/mailbox (LOH20A)

Standard	M608x, M609x (one)				
Optional	Add up to three: M608x, M609x <sup>25</sup> Add up to four: M607n, M607dn, M608n, M608dn, M609dn <sup>25</sup>	All models <sup>25</sup>	Add up to two: all models	All models	All models

## What's new

### HP LaserJet Enterprise M607 series compared to the HP LaserJet Enterprise M604 series



HP LaserJet Enterprise M607dn



HP LaserJet Enterprise M604dn



Benefits

Up to 52 ppm, simplex; up to 43 images per minute (ipm), duplex <sup>12,13</sup>	Up to 50 ppm, simplex; up to 33 ipm, duplex <sup>12</sup>	Save time with 4% faster simplex, 30% faster duplex <sup>13</sup>
FPO as fast as 5.1/7.9 seconds from ready/sleep <sup>10,11</sup>	FPO as fast as 7.5/10 seconds from ready/sleep <sup>10,11</sup>	Less wait time with up to 28% faster FPO from ready; 21% from sleep
100+ embedded security settings, <sup>3</sup> including HP Sure Start, run-time intrusion detection, whitelisting, and HP Connection Inspector	HP Sure Start not available; Whitelisting and run-time intrusion detection available with firmware upgrade	Enhanced protection with key security technologies designed to thwart attackers' efforts and self-heal
Up to 650-sheet standard input (4,400 maximum <sup>18</sup> ); input trays hold 550 sheets; optional 5-bin stapler/stacker/mailbox with job offset	Up to 600-sheet standard input (3,600 maximum <sup>18</sup> ); input trays hold 500 sheets; optional stapler/stacker/mailbox	Improved paper-handling options with 22% more maximum input; with 550-sheet trays, you can add a whole ream before the paper runs completely out
RMPV of 5,000 to 20,000 pages <sup>28</sup>	RMPV of 5,000 to 13,000 pages <sup>28</sup>	Print up to 54% more pages every month
Original HP Toner cartridges with JetIntelligence	Original HP Toner cartridges	Peak printing performance and anti-fraud technology





# What's new

## HP LaserJet Enterprise M608 series compared to the HP LaserJet Enterprise M605 series

		Benefits
<b>HP LaserJet Enterprise M608x</b>	HP LaserJet Enterprise M605x	
Up to 61 ppm, simplex; up to 50 ipm, duplex <sup>12,13</sup>	Up to 55 ppm, simplex; up to 36 ipm, duplex <sup>12</sup>	Save time with 11% faster simplex, 39% faster duplex <sup>13</sup>
FPO as fast as 5.1/7.9 seconds from ready/sleep <sup>10,11</sup>	FPO as fast as 7/9.5 seconds from ready/sleep <sup>10,11</sup>	Less wait time with up to 23% faster FPO from ready; 17% from sleep
100+ embedded security settings, <sup>3</sup> including HP Sure Start, run-time intrusion detection, whitelisting, and HP Connection Inspector	HP Sure Start not available; Whitelisting and run-time intrusion detection available with firmware upgrade	Enhanced protection with key security technologies designed to thwart attackers' efforts and self-heal
Up to 1,200-sheet standard input (4,400 maximum <sup>18</sup> ); input trays hold 550 sheets; optional 5-bin stapler/stacker/mailbox with job offset	Up to 1,100-sheet standard input (3,600 maximum <sup>18</sup> ); input trays hold 500 sheets; optional stapler/stacker/mailbox	Improved paper-handling options with 22% more maximum input; with 550-sheet trays, you can add a whole ream before the paper runs completely out
RMPV of 5,000 to 25,000 pages <sup>28</sup>	RMPV of 5,000 to 16,000 pages <sup>28</sup>	Print up to 56% more pages every month
Original HP Toner cartridges with JetIntelligence; Extra High Yield black (~41,000 pages) <sup>23,24</sup>	Original HP Toner cartridges; High Yield black cartridges (~25,000 pages) <sup>24</sup>	Peak printing performance and anti-fraud technology

# What's new

## HP LaserJet Enterprise M609 series compared to the HP LaserJet Enterprise M606 series

		Benefits
<b>HP LaserJet Enterprise M609x</b>	HP LaserJet Enterprise M606x	
Up to 71 ppm, simplex; up to 58 ipm, duplex <sup>12</sup>	Up to 62 ppm, simplex; up to 41 ipm, duplex <sup>12</sup>	Save time with 15% faster simplex, 41% faster duplex
FPO as fast as 5.1/7.9 seconds from ready/sleep <sup>10,11</sup>	FPO as fast as 7/9.5 seconds from ready/sleep <sup>10,11</sup>	Less wait time with up to 23% faster FPO from ready; 17% from sleep
100+ embedded security settings, <sup>3</sup> including HP Sure Start, run-time intrusion detection, whitelisting, and HP Connection Inspector	HP Sure Start not available; Whitelisting and run-time intrusion detection available with firmware upgrade	Enhanced protection with key security technologies designed to thwart attackers' efforts and self-heal
Up to 1,200-sheet standard input (4,400 maximum <sup>18</sup> ); input trays hold 550 sheets; optional 5-bin stapler/stacker/mailbox with job offset	Up to 1,100-sheet standard input (3,600 maximum <sup>18</sup> ); input trays hold 500 sheets; optional stapler/stacker/mailbox	Improved paper-handling options with 22% more maximum input; with 550-sheet trays, you can add a whole ream before the paper runs completely out
RMPV of 5,000 to 30,000 pages <sup>28</sup>	RMPV of 5,000 to 20,000 pages <sup>28</sup>	Print up to 50% more pages every month
Original HP Toner cartridges with JetIntelligence; Extra High Yield black (~41,000 pages) <sup>23,24</sup>	Original HP Toner cartridges; High Yield black cartridges (~25,000 pages) <sup>24</sup>	Peak printing performance and anti-fraud technology

# Technical specifications

	HP LaserJet Enterprise M607 series	HP LaserJet Enterprise M608 series	HP LaserJet Enterprise M609 series
<b>Product number</b>	M607n: K0Q14A M607dn: K0Q15A	M608n: K0Q17A M608dn: K0Q18A M608x: K0Q19A	M609dn: K0Q21A M609x: K0Q22A
<b>Control panel</b>	6.9 cm (2.7-inch) colour graphics display with keypad  M607dn: Plus Hardware Integration Pocket	M608n, M608dn: 6.9 cm (2.7-inch) colour graphics display with keypad  M608x: 10.9 cm (4.3-inch) colour touchscreen control panel  Plus Hardware Integration Pocket	M609dn: 6.9 cm (2.7-inch) colour graphics display with keypad  M609x: 10.9 cm (4.3-inch) colour touchscreen control panel  Plus Hardware Integration Pocket
Easy-access USB ( <i>all models</i> )			
<b>Print speed<sup>12</sup></b>			
Simplex	Up to 52 ppm, A4 (55 ppm, letter)  Up to 80/6 ppm, A5 (landscape/portrait) <sup>14</sup>	Up to 61 ppm, A4 (65 ppm, letter)  Up to 100/6 ppm, A5 (landscape/portrait) <sup>14</sup>	Up to 71 ppm, A4 (75 ppm, letter)  Up to 115/6 ppm, A5 (landscape/portrait) <sup>14</sup>
Duplex	Up to 43 ipm, A4 (45 ipm, letter)	Up to 50 ipm, A4 (53 ipm, letter)	Up to 58 ipm, A4 (62 ipm, letter)
<b>First page out<sup>10</sup></b>	As fast as 5.1 seconds from ready, A4 (5.0 seconds, letter); as fast as 7.9 seconds from sleep, A4 (7.8 seconds, letter) <sup>11</sup>		
<b>Print resolution</b>	FastRes1200 (600 × 600 × 8 dpi), 1200 × 1200 dpi ( <i>all models</i> )		
<b>Printing features</b>	Print preview, print multiple pages per sheet (2, 4, 6, 9, 16), collation, watermarks, store print jobs, easy-access USB		
<b>Processor</b>	1.2 GHz ( <i>all models</i> )		
<b>Memory</b>	512 MB, standard; 1.5 GB, maximum with purchase of 1 GB accessory DIMM ( <i>all models</i> )		
<b>Storage</b>	4 GB EMMC non-volatile storage; Firmware encryption (AES 128 or AES 256) of customer/job data; Secure Cryptographic Erase – Job Data, Secure Erase – Disk  Optional: HP High-Performance Secure Hard Disk, minimum 500 GB; AES 256 hardware encryption or greater; Secure erase capabilities (Secure File Erase – Temporary Job Files, Secure Erase – Job Data, Secure ATA Erase – Disk)		
<b>Durability ratings</b>			
Recommended monthly page volume <sup>28</sup>	5,000 to 20,000 pages	5,000 to 25,000 pages	5,000 to 30,000 pages
Duty cycle <sup>29</sup>	Up to 250,000 pages	Up to 275,000 pages	Up to 300,000 pages
<b>Media specifications</b>			
Input capacity	Up to 650 sheets (up to 4,400 maximum) Tray 1: Up to 100 sheets Tray 2: Up to 550 sheets	M608n, M608dn: Up to 650 sheets (up to 4,400 maximum) Tray 1: Up to 100 sheets Tray 2: Up to 550 sheets  M608x: Up to 1,200 sheets (up to 4,400 maximum) Tray 1: Up to 100 sheets Trays 2 and 3: Up to 550 sheets each	M609dn: Up to 650 sheets (up to 4,400 maximum) Tray 1: Up to 100 sheets Tray 2: Up to 550 sheets  M609x: Up to 1,200 sheets (up to 4,400 maximum) Tray 1: Up to 100 sheets Trays 2 and 3: Up to 550 sheets each
Output capacity	Up to 500 sheets (standard); up to 1,300 sheets with optional 5-bin stapler/stacker/mailbox accessory		
Two-sided printing	M607n: Manual M607dn: Automatic	M608n: Manual M608dn, M608x: Automatic	Automatic
Media sizes	Tray 1: A4, A5, A6, RA4, B5, B6 (JIS), Oficio (216 × 340 mm), 16K, 10 × 15 cm, postcards (JIS single and double), envelopes (C5, B5, C6, DL, ISO); letter, legal, statement, executive, Oficio (8.5 × 13 in), 3 × 5 in, 4 × 6 in, 5 × 7 in, 5 × 8 in, envelopes (No. 9, No. 10, Monarch (7 3/4)); Custom media sizes: 76 × 127 to 216 × 356 mm (3 × 5 to 8.5 × 14 in)  Tray 2, optional trays 3, 4, 5, and 6: A4, A5, A5-R, B5 (JIS), 16K; letter, legal, executive; Custom media sizes: 99 × 148 to 216 × 356 mm (3.9 × 5.8 to 8.5 × 14 in)  Duplex: A4, A5, RA4, B5 (JIS), Oficio (216 × 340 mm); letter, legal, executive  Optional 2,100-sheet feeder: A4, A5, A5-R, B5 (JIS), 16K; letter, legal, executive		
Media weights	Tray 1: 60 to 200 g/m <sup>2</sup> (16 to 53 lb) Tray 2+: 60 to 120 g/m <sup>2</sup> (16 to 32 lb)		
Media types	Paper (plain, light, bond, recycled, heavy, extra heavy, cardstock, pre-printed, pre-punched, coloured, rough, heavy rough), mono transparency, labels, letterhead, envelope, heavy envelope		
<b>Print languages</b>	HP PCL 6, HP PCL 5 (HP PCL 5 driver available from the Web only), HP postscript level 3 emulation, native PDF printing (v 1.7), Apple AirPrint		

	HP LaserJet Enterprise M607 series	HP LaserJet Enterprise M608 series	HP LaserJet Enterprise M609 series
Fonts	105 internal TrueType fonts scalable in HP PCL, 92 internal scalable fonts in HP postscript level 3 emulation (Euro symbol built-in); 1 internal Unicode font (Andale Mono WorldType); 2 Internal Windows Vista® 8 fonts (Calibri, Cambria); Additional font solutions available via third-party flash memory cards; HP LaserJet fonts and IPDS Emulation available at <a href="http://hp.com/go/laserjetfonts">hp.com/go/laserjetfonts</a>		
Connectivity	2 Hi-Speed USB 2.0 Host; 1 Hi-Speed USB 2.0 Device; 1 Gigabit Ethernet 10/100/1000T network		
Mobile printing	HP ePrint, <sup>30</sup> Apple AirPrint, <sup>31</sup> Mopria-certified, Google Cloud Print™ 2.0 ( <i>all models</i> )		
		Plus Wi-Fi Direct, <sup>15</sup> Bluetooth Low Energy <sup>16</sup> ( <i>M608x and M609x models</i> )	
	Optional wireless direct, <sup>15</sup> NFC touch-to-print <sup>26</sup> enabled with purchase of accessory ( <i>M607n, M607dn, M608n, M608dn, M609dn models</i> )		
Network capabilities	Via HP Jetdirect Ethernet embedded print server supports: 10Base-T, 100Base-Tx, 1000Base-T; 802.3az (EEE) support on Fast Ethernet and Gigabit Ethernet; IPsec ( <i>all models</i> )		
		Plus 802.11b/g/n wireless networking <sup>27</sup> ( <i>M608x and M609x models</i> )	
	Optional 802.11b/g/n wireless networking enabled with purchase of accessory <sup>27</sup> ( <i>M607n, M607dn, M608n, M608dn, M609dn models</i> )		
Network protocols	Via built-in networking solution: TCP/IP, IPv4, IPv6  Print: TCP-IP port 9100 Direct Mode, LPD (raw queue support only), Web Services Printing, IPP 2.0, Apple AirPrint, <sup>31</sup> HP ePrint, <sup>30</sup> FTP Print, Google Cloud Print  Discovery: SLP, Bonjour, Web Services Discovery  IP config: IPv4 (BootP, DHCP, AutoIP, Manual, TFTP Config, ARP-Ping), IPv6 (Stateless Link-Local and via Router, Statefull via DHCPv6)  Management: SNMPv2/v3, HTTP/HTTPS, Telnet, TFTP Config, FTP FW Download, Syslog  Security: SNMPv3, SSL Cert Management, Firewall, ACL, 802.1x		
Security	Identity Management: Kerberos authentication, LDAP authentication, 1000 user PIN codes, optional HP and third-party advanced authentication solutions (e.g., badge readers)  Network: IPsec/firewall with Certificate, Pre-Shared Key, and Kerberos authentication, Supports WJA-10 IPsec configuration Plug in, 802.1X authentication (EAP-PEAP, EAP-TLS), SNMPv3, HTTPS, Certificates, Access Control List  Data: Storage Encryption, Encrypted PDF and email (uses FIPS 140 validated cryptographic libraries from Microsoft®), Secure Erase, SSL/TLS (HTTPS), Encrypted Credentials  Device: Security lock slot, USB port disablement, Hardware Integration Pocket for security solutions, <sup>5</sup> Intrusion Detection with Red Balloon Security Technology - Constant in-device monitoring for attacks, HP SureStart Secure Boot - BIOS Integrity Checking with self-healing capability, Whitelisting - loads only known good code (DLLs, EXEs, etc.)  Security Management: Compatible with HP JetAdvantage Security Manager, <sup>8</sup> Device Security Syslog Messages processed and accessible in ArcSight, Splunk, and McAfee SIEMs		
Compatible operating systems <sup>32</sup>	Windows® OS: Windows 10 all 32- and 64-bit editions (excluding RT OS for Tablets), Windows 7 all 32- and 64-bit editions, Windows 8/8.1 all 32- and 64-bit editions (excluding RT OS for Tablets), Windows Vista all 32-bit editions (Home Basic, Premium, Professional, etc.), Windows XP SP3 32-bit editions (XP Home, XP Pro, etc.)  Mac OS: 10.12 Sierra, OS X 10.10 Yosemite, OS X 10.11 El Capitan  Mobile OS: Android™  Linux® Boss (5.0), Linux Debian (7.0, 7.1, 7.2, 7.3, 7.4, 7.5, 7.6, 7.7, 7.8, 7.9, 8.0, 8.1, 8.2, 8.3, 8.4, 8.5, 8.6), Linux Fedora (22, 23, 24), Linux Mint (17, 17.1, 17.2, 17.3, 18), Linux Red Hat Enterprise (6.0, 7.0), Linux SUSE (13.2, 42.1), Linux Ubuntu (12.04, 14.04, 15.10, 16.04, 16.10)  Other OS: UNIX®		
Compatible network operating systems	Citrix® MetaFrame Presentation Server 3.0, Citrix MetaFrame XP Presentation Server (Feature Release 1, 2, and 3), Citrix on Windows Server® 2003/2003R2, Citrix on Windows Server 2008/2008R2/2008 R2 SP1, Citrix on Windows Server 2012/2012R2, Citrix Presentation Server 4.0/4.5, Citrix XenApp 5.0 (Plus Feature Pack 2 and 3) for Windows Server 2008 Terminal Services 32- and 64-bit, Citrix XenApp 6.0/6.5 [for Windows Server 2008 R2 Terminal Services, 32- and 64-bit], Citrix XenApp 6.0/6.5/7.5 [for Windows Server 2008 R2 SP1 Terminal Services, 32- and 64-bit], Citrix XenApp 7.5 [for Windows Server 2012 and 2012 R2 Terminal Services, 64-bit], Citrix XenDesktop® 5.6 [for Windows Server 2008 R2 Terminal Services, 32- and 64-bit], Citrix XenDesktop 5.6/7.0/7.5 [for Windows Server 2008 R2 SP1 Terminal Services, 32- and 64-bit], Citrix XenDesktop 7.0/7.5 [for Windows Server 2012 and 2012 R2 Terminal Services, 64-bit]  Novell NetWare 6.5/SP8 Novell Clients <a href="http://novell.com/iprint">novell.com/iprint</a> , Novell iPrint Appliance v1.0, Novell Open Enterprise Server 11/SP1, Novell Open Enterprise Server 2 for Linux, Novell Servers <a href="http://novell.com/iprint">novell.com/iprint</a>  Windows Server 2003/2003 R2 32-/64-bit (SP1/SP2) Standard/Enterprise/Datacenter (+ Cluster and Terminal Services), Windows Server 2003/2003 R2 32-bit (SP1/SP2), Standard/Enterprise (+ Cluster and Terminal Services), Windows Server 2008 32-/64-bit (SP2) Standard/Enterprise (+ Cluster and Terminal Services), Windows Server 2008 R2 64-bit (SP1) Standard/Enterprise (+ Cluster and Terminal Services), Windows Server 2008/2008 R2 32-/64-bit (SP1/SP2) Standard/Enterprise/Datacenter (+ Cluster and Terminal Services), Windows Server 2012/2012 R2 64-bit Standard/Foundation/Essentials/Datacenter (+ Cluster and Terminal Services), Windows Server 2016/ 64-bit Standard/Essential/Datacenter (+ Cluster and Terminal Services)		

	HP LaserJet Enterprise M607 series	HP LaserJet Enterprise M608 series	HP LaserJet Enterprise M609 series
<b>System requirements, Windows</b>	A compatible operating system (see above), 2 GB available hard disk space, OS compatible hardware (for OS hardware requirements see <a href="https://www.microsoft.com">microsoft.com</a> )		
<b>System requirements, Macintosh</b>	A compatible operating system (see above), 1.3 GB available hard disk space (for operating system compatible hardware requirements see <a href="https://www.apple.com">apple.com</a> )		
<b>Dimensions, operating (width x depth x height)</b>	431 x 466 x 380 mm (17 x 18.3 x 15 in)	M608n, M608dn: 431 x 466 x 380 mm (17 x 18.3 x 15 in) M608x: 431 x 466 x 505 mm (17 x 18.3 x 19.9 in)	M609dn: 431 x 466 x 380 mm (17 x 18.3 x 15 in) M609x: 431 x 466 x 505 mm (17 x 18.3 x 19.9 in)
<b>Dimensions, maximum<sup>33</sup> (width x depth x height)</b>	431 x 1040 x 453 mm (17 x 40.9 x 17.8 in)	M608n, M608dn: 431 x 1040 x 453 mm (17 x 40.9 x 17.8 in) M608x: 431 x 1100 x 581 mm (17 x 43.3 x 22.9 in)	M609dn: 431 x 1040 x 453 mm (17 x 40.9 x 17.8 in) M609x: 431 x 1100 x 581 mm (17 x 43.3 x 22.9 in)
<b>Weight (with print cartridges)</b>	21.6 kg (47.7 lb)	M608n, M608dn: 21.6 kg (47.7 lb) M608x: 26.3 kg (58 lb)	M609dn: 21.6 kg (47.7 lb) M609x: 26.3 kg (58 lb)
<b>What's in the box</b>	HP LaserJet Printer, HP Black Original LaserJet Toner Cartridge (~11,000 pages), <sup>24</sup> CD with software drivers and documentation, Documentation (Hardware Install Guide), Power cord		
	M607dn: Plus automatic duplexer (built-in)	M608dn: Plus automatic duplexer (built-in) M608x: Plus automatic duplexer (built-in), 500-sheet input feeder 3	M609dn: Plus automatic duplexer (built-in) M609x: Plus automatic duplexer (built-in), 500-sheet input feeder 3
<b>Software included</b>	HP Connected, HP Device Experience (DXP), HP PCL 6 Printer Driver, HP Software Installer/Uninstaller, Mac OS Welcome Screen (Directs users to <a href="https://123.hp.com">123.hp.com</a> or OS App Source for printer software), Online user manuals		
<b>Downloadable software</b>	HP Easy Start (Guided Software Install for Windows OS and Mac); HP ePrint Software (ePrint Mobile Driver for Windows); HP ePrint Software (for Windows); HP JetAdvantage Security Manager; <sup>8</sup> HP Mobile Printing <a href="https://hp.com/us/en/ads/mobility/overview.html">hp.com/us/en/ads/mobility/overview.html</a> ; HP PCL6 print driver only (No installer for "Add Printer" installs); HP PCL6 print driver with installer, Product Documentation and Support; HP Proxy Agent Software; HP Universal Print Drivers (PCL6 and PS for Windows); <sup>34</sup> Linux/Unix Print Drivers; Mac Software Solution; Printer Administrator Resource Kit; SAP (PS Print Drivers); HP Web Jetadmin; <sup>7</sup> Windows driver only solution; Windows Full Software Solution		
<b>Warranty</b>	One-year, next-business day, onsite warranty		
	Warranty and support options vary by product, country and local legal requirements. Go to <a href="https://hp.com/support">hp.com/support</a> to learn about HP world-class service and support options in your region.		

# Environmental and power specifications

	HP LaserJet Enterprise M607 series	HP LaserJet Enterprise M608 series	HP LaserJet Enterprise M609 series
Environmental ranges			
Temperatures	Operating: 15 to 32.5° C (59 to 90.5° F); Recommended operating: 15 to 27° C (59 to 80.6° F); Storage: -20 to 40° C (-4 to 104° F)		
Relative Humidity	Operating range: 10 to 80% RH; Recommended operating range: 30 to 70% RH; Storage range: 10 to 90% RH		
Acoustic power emissions <sup>35</sup>	Ready mode: Inaudible Printing mono, simplex A4 at 53 ppm: 6.9 B(A) printing	Ready mode: Inaudible Printing mono, simplex A4 at 62 ppm: 6.9 B(A) printing	Ready mode: Inaudible Printing mono, simplex A4 at 71 ppm: 6.9 B(A) printing
Acoustic pressure emissions (bystander)			
Ready mode	Inaudible ( <i>all models</i> )		
Active mode	Printing mono, simplex A4 at 53 ppm: 55 dB(A)	Printing mono, simplex A4 at 62 ppm: M608n, M608dn: 55 dB(A) M608x: 54 dB(A)	Printing mono, simplex A4 at 71 ppm: M609dn: 56 dB(A) M609x: 55 dB(A)
Power specifications <sup>36</sup>			
Power supply	Built-in 115V or 220V (Not dual voltage, power supply varies by part number with # option code identifier) 100 V-127 V nominal @ +/-10% (min 90 V, max 140 V); 50-60 Hz nominal +/- 3 Hz (min 47 Hz, max 63 Hz); 12 A 220 V-240 V nominal @ +/-10% (min 198 V, max 264 V); 50-60 Hz nominal +/- 3 Hz (min 47 Hz, max 63 Hz); 6 A		
Power consumption	Active: 780 watts, Ready: 15.3 watts, Sleep: 3.1 watts, Off/Auto-off: <0.1 watts		
Typical electricity consumption (TEC)	1.971 kWh/week (Blue Angel); 2.131 kWh/week (ENERGY STAR®)	2.425 kWh/week (Blue Angel); 2.622 kWh/week (ENERGY STAR)	2.948 kWh/week (Blue Angel); 3.173 kWh/week (ENERGY STAR)
Energy-saving features	HP Auto-On/Auto-Off Technology; <sup>21</sup> Instant-on Technology; Instant-on Copy		
Environmental specifications			
	All models: Blue Angel compliant, ENERGY STAR® certified; CECP; EPEAT® Silver <sup>37</sup>		
		M608dn: Plus optional EPEAT® Gold <sup>37</sup>	M609dn: Plus optional EPEAT® Gold <sup>37</sup>
Safety and regulatory compliance	IEC 60950-1:2005 +A1:2009 +A2:2013 (International); EN60950-1:2006 +A11:2009 +A1:2010 +A12:2011 +A2:2013 (EU); EN 60825-1:2007 / IEC 60825-1:2007 (Class 1 Laser Product); EN 62479:2010 / IEC 62479:2010; Low Voltage Directive 2006/95/EC with CE Mark (Europe); GS Certificate (Germany, Europe); UL/cUL Listed and UC CoC (US/Canada); CAN/CSA C22.2 No. 60950-1-07 2nd Ed. 2011-12; Compliance with Laser safety standards 21 CFR 1040.10 and 1040.11 except for deviations pursuant to Laser notice No. 50, dated June 24, 2007; Other safety approvals as required by individual countries		
Electromagnetic emission standard	CISPR 22:2008 (International) - Class A; EN 55022: 2010 (EU) - Class A; EN 61000-3-2: 2006 +A1: 2009 +A2: 2009; EN 61000-3-3: 2008; EN 55024: 2010; EMC Directive 2004/108/EC; FCC CFR 47 Part 15 Class A / ICES-003, Issue 5 Class A; Other EMC approvals as required by individual countries		
Telecom compliance certification	M608x, M609x: Telecom wireless: EN301 489-1 v1.9.2/EN 301 489-1v2.2.1 (2012-09) EN300 328 v1.9.1, FCC Title 47 CFR Part 15 Subpart C (section 15.247)/IC:RSS-210 IEC 62311:2007/EN62311:2008 and other Telecom approvals as required by individual countries.		

# Ordering information

Use accessories and supplies specifically designed for the printer to help provide efficient performance. To order the accessories and supplies listed here, go to [hp.com](http://hp.com). To contact HP by country, please visit [hp.com/go/contact](http://hp.com/go/contact). If you don't have access to the Internet, contact your qualified HP dealer.

<b>LaserJet</b>	HP LaserJet Enterprise M607n	K0Q14A
	HP LaserJet Enterprise M607dn	K0Q15A
	HP LaserJet Enterprise M608n	K0Q17A
	HP LaserJet Enterprise M608dn	K0Q18A
	HP LaserJet Enterprise M608x	K0Q19A
	HP LaserJet Enterprise M609dn	K0Q21A
	HP LaserJet Enterprise M609x	K0Q22A
<b>Supplies</b>	HP 37A Black Original LaserJet Toner Cartridge (~11,000 pages) <sup>24</sup>	CF237A
	HP 37X High Yield Black Original LaserJet Toner Cartridge (~25,000 pages) <sup>24</sup>	CF237X
	HP 37Y Extra High Yield Black Original LaserJet Toner Cartridge (~41,000 pages) <sup>24</sup>	CF237Y
	HP LaserJet 220V Maintenance Kit (225,000 pages)	L0H25A
	HP Staple Cartridge Refill (5,000 staples)	J8J96A
<b>Accessories</b>	HP LaserJet 550-sheet paper feeder	L0H17A
	HP LaserJet 2,100-sheet paper feeder	L0H18A
	HP LaserJet Printer Stand	L0H19A
	HP LaserJet Stapler/Stacker/Mailbox	L0H20A
	HP Envelope Feeder	L0H21A
	HP Extension Tray Cover	L0H22A
	HP Internal USB Ports (AA Module - CSR-A)	B5L28A
	HP High-Performance Secure Hard Disk (FIPS - CSR-A)	B5L29A
	HP Jetdirect 2900nw Print Server <sup>27</sup>	J8031A
	HP Jetdirect 3000w NFC/Wireless Direct Accessory <sup>15,26</sup>	J8030A
	HP Trusted Platform Module Accessory	F5S62A
	1 GB memory DIMM Kit	G6W84A
<b>HP Services</b>		
<p>Improve performance—it's your choice. HP Care provides options to help you manage imaging and printing—from Care Pack services to customisable and advisory services. With HP Managed Print Services, we oversee everything for you.</p>	<p>Make sure your imaging and printing investments are protected with Care Pack, part of HP Care. Pick your package of services to keep your printer running and your business moving. Now your office can spend less time trouble-shooting and more time getting things done. For details, visit <a href="http://hp.com/go/cpc">hp.com/go/cpc</a>.<sup>38</sup></p>	
	HP 3-year Next Business Day + Defective Media Retention LJ Ent M607 Hardware Support	U9MU0E
	HP 5-year Next Business Day + Defective Media Retention LJ Ent M607 Hardware Support	U9MU2E
	HP 1-year Post Warranty Next Business Day + Defective Media Retention LJ Ent M607 HW Support	U9MW4PE
	HP 3-year Next Business Day + Defective Media Retention LJ Ent M608 Hardware Support	U9NE0E
	HP 5-year Next Business Day + Defective Media Retention LJ Ent M608 Hardware Support	U9NE2E
	HP 1-year Post Warranty Next Business Day + Defective Media Retention LJ Ent M608 HW Support	U9NG4PE
	HP 3-year Next Business Day + Defective Media Retention LJ Ent M609 Hardware Support	U9MZ0E
	HP 5-year Next Business Day + Defective Media Retention LJ Ent M609 Hardware Support	U9MZ2E
	HP 1-year Post Warranty Next Business Day + Defective Media Retention LJ Ent M609 HW Support	U9NB4PE
<b>Solutions</b>		
<p>HP Web Jetadmin: <a href="http://hp.com/go/wja">hp.com/go/wja</a></p> <p>HP Universal Print Driver: <a href="http://hp.com/go/upd">hp.com/go/upd</a></p> <p>HP JetAdvantage Security Manager: <a href="http://hp.com/go/securitymanager">hp.com/go/securitymanager</a></p> <p>HP JetAdvantage On Demand Cloud Solutions: <a href="http://hp.com/go/JetAdvantageondemand">hp.com/go/JetAdvantageondemand</a></p> <p>HP LaserJet fonts, barcodes, and IPDS Emulation available at <a href="http://hp.com/go/laserjetfonts">hp.com/go/laserjetfonts</a></p> <p>To learn more about available infrastructure, management, and workflow solutions, visit <a href="http://hp.com/go/printing_solutions">hp.com/go/printing_solutions</a></p>		



# Appendix A: Control panel features

## Upgrade to a modern interface

The HP LaserJet Enterprise M607/M608/M609 series is powered by HP FutureSmart 4.0 firmware. Its modern, tablet-like interface keeps things simple and intuitive across your fleet of Enterprise devices. A scalable control panel interface improves future extensibility and provides a robust set of new apps and usability features. The new Message Center, with more detailed information and helpful animations, makes it easy to address device events. The simplified home screen displays just three core apps by default (two apps for models with the 6.9 cm colour graphics display). Additional apps are easily accessed by swiping right to left, like with a smartphone or tablet.

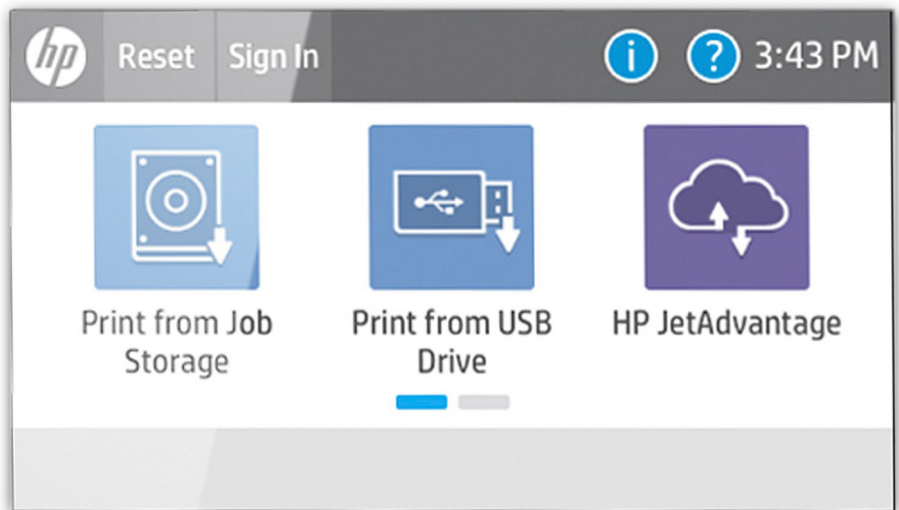

## Troubleshoot with ease

The HP LaserJet Enterprise M607/M608/M609 series can help save your IT department valuable time when it comes to troubleshooting problems. The Remote Control Panel allows users to operate the user interface remotely, so IT can troubleshoot problems without running to the printer.<sup>39</sup> Users can also quickly troubleshoot technical issues with HP's innovative, cloud-based Online Help services that are relevant and up to date. Easily solve problems from your PC or mobile device. A Quick Response (QR) code on the touchscreen links to Online Help using smart phones and tablets.<sup>40</sup> You can also find these links in the HP Embedded Web Server event log.

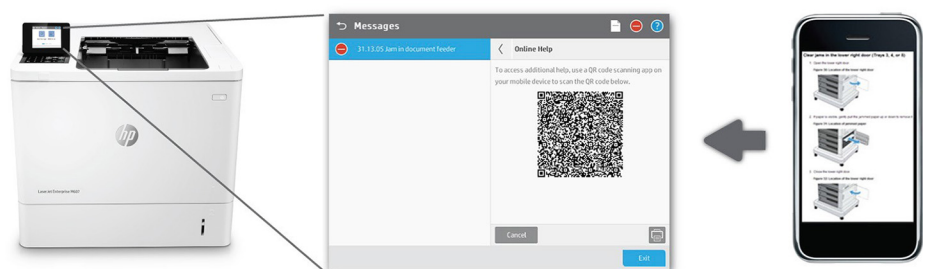

- <sup>1</sup> Based on HP review of 2018 published security features of competitive in-class printers. Only HP offers a combination of security features that can monitor to detect and automatically stop an attack then self-validate software integrity in a reboot. For a list of printers, visit [hp.com/go/PrintersThatProtect](http://hp.com/go/PrintersThatProtect). For more information: [hp.com/go/printersecurityclaims](http://hp.com/go/printersecurityclaims).
- <sup>2</sup> Based on the reduced energy use of HP LaserJet printers and cartridges with JetIntelligence introduced since 2015 compared to previous toner versions without JetIntelligence, using ENERGY STAR® methodology.
- <sup>3</sup> Some features require additional purchase. A FutureSmart service pack update may be required to activate security features. Learn more at [hp.com/go/printsecurity](http://hp.com/go/printsecurity).
- <sup>4</sup> HP Proximity Card Reader (CZ208A) is available for separate purchase for select HP devices with Hardware Integration Pocket (HIP) and touchscreen display.
- <sup>5</sup> Solutions deployed through the Hardware Integration Pocket (HIP) may require additional purchase. HIP not available on the HP LaserJet Enterprise M607n.
- <sup>6</sup> Use of the optional HP Trusted Platform Module accessory may require a firmware upgrade.
- <sup>7</sup> HP Web Jetadmin is available for download at no additional charge at [hp.com/go/wja](http://hp.com/go/wja).
- <sup>8</sup> HP JetAdvantage Security Manager must be purchased separately. For details, see [hp.com/go/securitymanager](http://hp.com/go/securitymanager).
- <sup>9</sup> HP JetAdvantage Secure Print works with any network-connected printer or MFP. On-device authentication is available for many HP LaserJet, PageWide, and OfficeJet Pro devices and selected non-HP devices. Some devices may require a firmware upgrade. Internet connection required for cloud storage and retrieval of print jobs. Print-job release from a mobile device requires a network connection and QR code. For more information and a list of supported printers and MFPs, see [hp.com/go/JetAdvantageSecurePrint](http://hp.com/go/JetAdvantageSecurePrint).
- <sup>10</sup> Measured using ISO/IEC 17629. Exact speed varies depending on the system configuration, software application, driver, and document complexity. Learn more at [hp.com/go/printerclaims](http://hp.com/go/printerclaims).
- <sup>11</sup> Measured after 15 minutes in sleep. Exact speed varies depending on the system configuration, software application, driver, document complexity and time in sleep.
- <sup>12</sup> Measured using ISO/IEC 24734; excludes first set of test documents. For more information, see [hp.com/go/printerclaims](http://hp.com/go/printerclaims). Exact speed varies depending on the system configuration, software application, driver, and document complexity.
- <sup>13</sup> Automatic two-sided printing is not supported on the HP LaserJet Enterprise M607n and M608n models.
- <sup>14</sup> Measured using ISO 24734 Feature Test, A5 Landscape Feed. Speed may vary based on content, PC, media orientation, and media type. A5 landscape printing cannot be duplexed.
- <sup>15</sup> Wi-Fi Direct printing is embedded in the HP LaserJet Enterprise M608x and M609x models. All other models can add wireless direct with the purchase of the optional HP Jetdirect 3000w NFC/Wireless Direct Accessory. Mobile device needs to be connected directly to the signal of a Wi-Fi Direct® supported MFP or printer prior to printing. Depending on mobile device, an app or driver may also be required. For details, see [hp.com/go/mobileprinting](http://hp.com/go/mobileprinting). Wi-Fi Direct is a registered trademark of Wi-Fi Alliance®.
- <sup>16</sup> Bluetooth Low Energy is standard only on the HP LaserJet Enterprise M608x and M609x models, and it cannot be added to other models. Bluetooth® is a trademark owned by its proprietor and used by HP Inc. under license.
- <sup>17</sup> Requires purchase of server software such as HP PrinterOn Enterprise or HP Access Control Secure Pull Printing. Learn more at [hp.com/go/businessmobileprinting](http://hp.com/go/businessmobileprinting).
- <sup>18</sup> Purchase of optional paper trays required to reach maximum input capacity.
- <sup>19</sup> An administrator must enable the easy-access USB port before use.
- <sup>20</sup> Energy claim based on TEC data reported on [energystar.gov](http://energystar.gov) as of January 2017. Data normalised to determine energy efficiency of in-class laser printers with published speed of 55 to 75 ppm (letter). Subject to device settings. Actual results may vary.
- <sup>21</sup> HP Auto-On/Auto-Off Technology capabilities are subject to printer and settings.
- <sup>22</sup> Compared with products that use traditional fusing.
- <sup>23</sup> HP 37X High Yield and 37Y Extra High Yield Black Original LaserJet Toner cartridges are not included in printer purchase; purchase separately. Learn more at [hp.com/go/learnaboutsplies](http://hp.com/go/learnaboutsplies). The HP LaserJet Enterprise M607 series does not support the HP 37X or 37Y cartridges.
- <sup>24</sup> Toner cartridge yields established using ISO/IEC test standards. Actual yields and costs vary considerably depending on images printed, number of colour pages printed, and other factors.
- <sup>25</sup> All models come standard with the 100-sheet multipurpose tray and 550-sheet tray 2. The HP LaserJet Enterprise M608x and M609x models come with one additional 550-sheet paper feeder standard, and can add up to three additional optional 550-sheet paper feeders and the optional 2,100-sheet HCI feeder. The M607n, M607dn, M608n, M608dn, and M609dn models can add up to four additional optional 550-sheet paper feeders and the optional 2,100-sheet HCI feeder.
- <sup>26</sup> Touch-to-print capability is optional for all models (except M608x and M609x) with purchase of the optional HP Jetdirect 3000w NFC/Wireless Direct Accessory. Mobile device must support Near Field Communication (NFC)-enabled printing. For more information, see [hp.com/go/businessmobileprinting](http://hp.com/go/businessmobileprinting).
- <sup>27</sup> Wireless networking is optional for all models (except M608x and M609x) with purchase of the optional HP Jetdirect 2900nw Print Server. Wireless performance is dependent on physical environment and distance from access point, and may be limited during active VPN connections.
- <sup>28</sup> HP recommends that the number of printed pages per month be within the stated range for optimum device performance, based on factors including supplies replacement intervals and device life over an extended warranty period.
- <sup>29</sup> Duty cycle is defined as the maximum number of pages per month of imaged output. This value provides a comparison of product robustness in relation to other HP LaserJet or HP Color LaserJet devices, and enables appropriate deployment of printers and MFPs to satisfy the demands of connected individuals or groups.
- <sup>30</sup> Printer requires ePrint account registration. App or software may be required. Wireless operations are compatible with 2.4 GHz operations only. Learn more at [hp.com/go/mobileprinting](http://hp.com/go/mobileprinting).
- <sup>31</sup> Supports the following devices running iOS 4.2 or later: iPad, iPad 2, iPhone (3GS or later), iPod touch (3rd generation or later). Works with HP's AirPrint-enabled printers and requires the printer be connected to the same network as your iOS device. Wireless performance is dependent on physical environment and distance from the access point.
- <sup>32</sup> Full solution software available only for Windows 7 and newer, UPD software available only for Windows 7 and newer, HP Software for Mac and Windows is no longer included on the CD, but can be downloaded from [123.hp.com](http://123.hp.com). Legacy Windows Operating Systems (XP, Vista, and equivalent servers) get print and Scan drivers only with a reduced feature set, Windows RT OS for Tablets (32- and 64-bit) uses a simplified HP print driver built into the RT OS.
- <sup>33</sup> Maximum dimensions of the device are measured with all paper trays folded out and standard accessories installed.
- <sup>34</sup> The HP Universal Print Driver is available for download at no additional charge at [hp.com/go/upd](http://hp.com/go/upd).
- <sup>35</sup> Acoustic values are subject to change. For current information, see [hp.com/support](http://hp.com/support).
- <sup>36</sup> Power requirements are based on the country/region where the scanner is sold. Do not convert operating voltages. This will damage the device and void the product warranty.
- <sup>37</sup> EPEAT® registered where applicable. EPEAT registration varies by country. See [epeat.net](http://epeat.net) for registration status by country.
- <sup>38</sup> Service levels and response times may vary depending on your geographic location. Service starts on date of hardware purchase. Restrictions and limitations apply. For details, visit [hp.com/go/cpc](http://hp.com/go/cpc).
- <sup>39</sup> Availability dependent on firmware or software updates or upgrades.
- <sup>40</sup> Online Help must be enabled on the printer or MFP. Mobile device must have an Internet connection to access online services.

Sign up for updates  
[hp.com/go/getupdated](http://hp.com/go/getupdated)



© Copyright 2017-2019 HP Development Company, L.P. The information contained herein is subject to change without notice. The only warranties for HP products and services are set forth in the express warranty statements accompanying such products and services. Nothing herein should be construed as constituting an additional warranty. HP shall not be liable for technical or editorial errors or omissions contained herein.

AirPrint, Apple, iPad, iPhone, and iPod touch are trademarks of Apple Inc. Android and Google Cloud Print are trademarks of Google Inc. Bluetooth is a trademark owned by its proprietor and used by HP Inc. under license. Citrix and XenDesktop are registered trademarks of Citrix Systems, Inc. and/or one more of its subsidiaries, and may be registered in the United States Patent and Trademark Office and in other countries. ENERGY STAR is a registered trademark owned by the U.S. Environmental Protection Agency. Linux is the registered trademark of Linus Torvalds in the U.S. and other countries. Microsoft, Windows, Windows Server, and Windows Vista are U.S. registered trademarks of the Microsoft group of companies. UNIX is a registered trademark of The Open Group.

4AA6-9364EEE, October 2019, Rev. 6

