

Lenovo

V30a-24IML

Setup Guide

The Lenovo logo is positioned vertically on the right side of the page. It consists of the word "Lenovo" in white, sans-serif font, centered within a solid red rectangular background.

For Barcode Position Only

Printed in China
PN: SP40K37490

Initial Setup

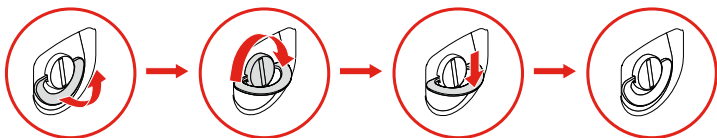
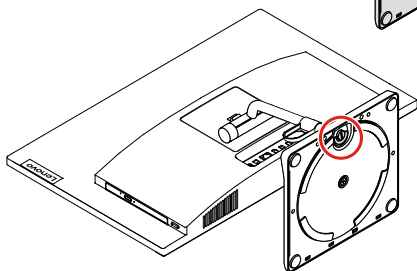
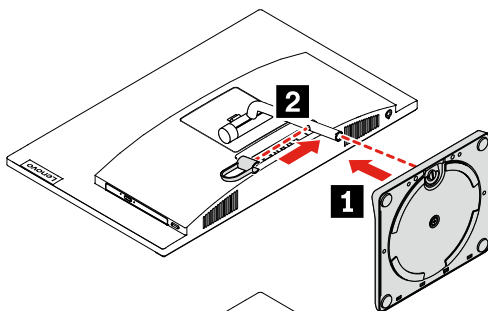
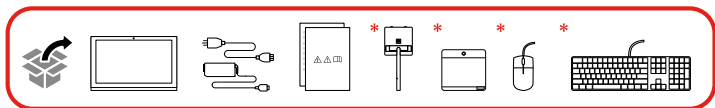

* For selected models

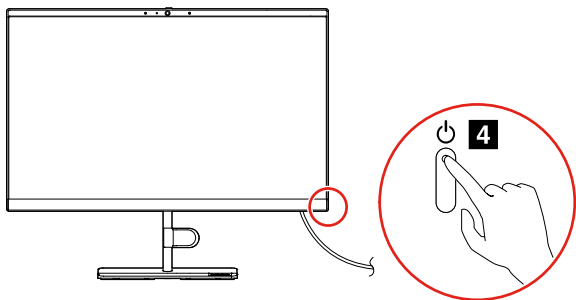
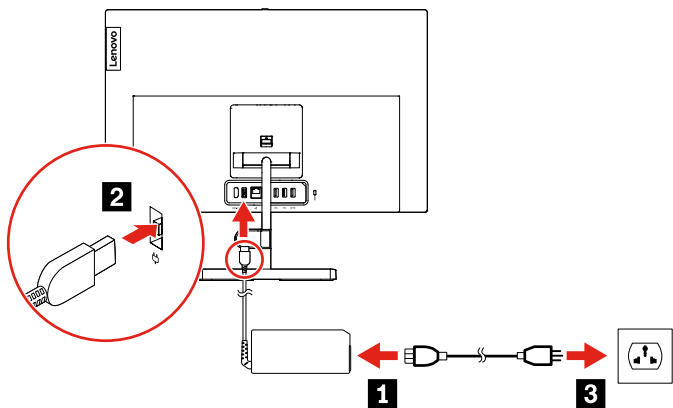

Overview

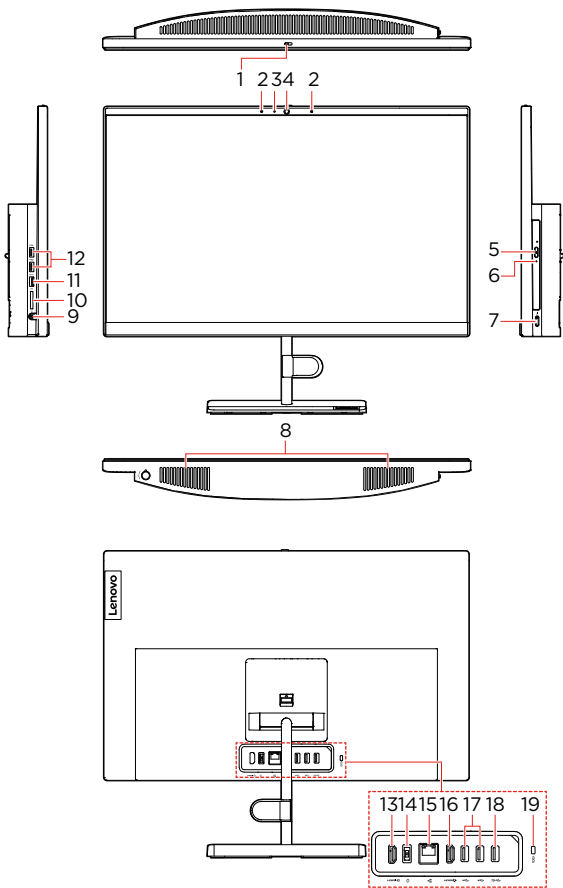

- * 1. Integrated camera shield
- * 2. Integrated microphones (2)
- * 3. Integrated camera activity indicator
- * 4. Integrated camera
- * 5. Optical drive eject button
- * 6. Optical drive activity indicator
- 7. Power button
- 8. Internal speakers (2)
- 9. Headset connector
- 10. SD-card slot
- 11. USB 3.2 connector Gen 2
- 12. USB 2.0 connectors (2)
- 13. HDMI™ 1.4 in connector
- 14. Power adapter connector
- 15. Ethernet connector
- 16. HDMI 1.4 out connector
- 17. USB 2.0 connectors (2)
- 18. USB 3.2 connector Gen 2
- 19. Security-lock slot

 Read the statement on USB transfer rate in the *User Guide*. Refer to the *Safety and Warranty Guide* for accessing the *User Guide*.

Customer Replacement Units (CRUs)

- Computer cover
- * • Computer stand bar
- * • Computer stand base
- Internal speakers
- * • Keyboard
- * • Mouse
- Power adapter
- Power cord
- Storage drive

Refer to the *User Guide* for CRU definition.

Additional information

European Union – compliance with the Radio Equipment Directive

Hereby, Lenovo (Singapore) Pte. Ltd., declares that the radio equipment type Lenovo V30a-24IML is in compliance with Directive 2014/53/EU.

The full text of the system EU declaration of conformity is available at the following Internet address:

<https://www.lenovo.com/us/en/compliance/eu-doc>

This radio equipment operates with the following frequency bands and maximum radio-frequency power:

Technology	Frequency band [MHz]	Maximum transmit power
WLAN 802.11b/g/n	2400 - 2483.5	< 20 dBm
WLAN 802.11a/n/ac	5150 - 5725	< 23 dBm
WLAN 802.11a/n/ac	5725 - 5875	< 13.98 dBm
Bluetooth BR/EDR/LE	2400 - 2483.5	< 20 dBm

Usage of all the radio devices is limited to indoor in the band 5150 MHz to 5350 MHz (channels 36, 40, 44, 48, 52, 56, 60, 64).



First Edition (February 2020)

© Copyright Lenovo 2020.

LIMITED AND RESTRICTED RIGHTS NOTICE: If data or software is delivered pursuant to a General Services Administration "GSA" contract, use, reproduction, or disclosure is subject to restrictions set forth in Contract No. GS-35F-05925.

Reduce | Reuse | Recycle

