



19" CK-Line FREE STANDING CABINETs



W=600mm CK-Line Free Standing Cabinets

The CK-Line product range is developed for Networking and Servering structure needs, with the most economic offer carrying the all necessity functions required in the structure of network and server applications.

The fully automated industry applied production gives the maximum optimized output of quality and cost, by this way the product range hits to its target of achievement.

The 600 series is available in 8 heights from 12U through to 42U, and in certain sizes a choice of depth is also available including 600, 800 and 1000mm options. Each cabinet is supplied as standard with a glass front door, steel rear door and lift off steel side panels, all of which are lockable. The 800 wide series are starting from 32 to 42U size.

The wide product height portfolio meets any U requirement in infrastructure needs.

CK-Line series have a professional technical but aesthetic look with decorative Metal Housing on the front door; the product range attracts the attention with the mostly environmentally fit and selected color of RAL 9005 Black, and RAL 7035 Light Grey, with fine wrinkle soft touch paint.

The product range allows with 1000mm depth versions, usage in private / low density server and storage applications. As well D1000mm versions offered with %63 perforated front and rear doors for better removal of thermal load inside rack for low density server and storage applications

Completely standard and stocked product portfolio, being delivered as a single piece assembled product, as shipping configuration the adjustable feet group is included.

CK-Line series product range with optimal panel mounting size, and a variety range of accesories enclose the whole expectation of users.

W600xD600mm



W600xD800mm



W600xD1000mm



CONSTRUCTION DETAILS:

Main Profile- Framework- Top/Bottom Cases:

Multi Folded Automated Bending technology applied corner profile system, provides a heavy duty structure results to high load capacity of: 600 kgs.

Monoblock multi folded top and bottom cases, tightly fixed to the framework with fixing hardware rivets.

Top case has a ready Forced Ventilation (Fan Module) integration housing.

Fan Module installation is from inside of enclosure.

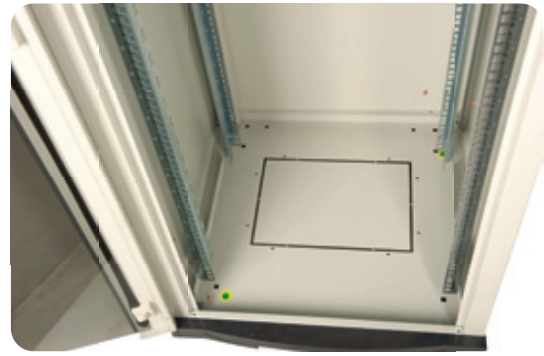

There are 2 pcs Dummy PVC Plates closing the roof cable entry on top, at W600mm cabinets. Also at W800mm cabinets these dummy cover plates are located at both left and right side of the roof and bottom case. Only W600mm x D600mm roof is already integrated with brushed cable entry due to less space on roof combination with cable entry & Fan Module Housing.

Once needed, any of these 2pcs Dummy Plates can be removed, to insert the cables from requested partition of either bottom case or top case, even both, in order to allow higher density cable insertion to the enclosure.

As accessory a brush set is offered as 300x55mm size, whenever the cable entry required to be with a protection for the falling dust, this accessory can be used. See accessory section for request.



Bottom case integrated with a large knock-out plate, once cables to come from bottom easily removed and cables to insert. Once a better protection for cables, as well for dust entry, the knock-out provision can be integrated with the rubber edged sliding mechanism on the cable entry point at bottom with w=350mmxd=250mm.

On rubber edged sliding mechanism max cable entry opening is w=350xd=150mm.

After inserting the cables, the rubber edged mechanism holds and fixes the cables in parallel preventing the cabinet from dust entry.

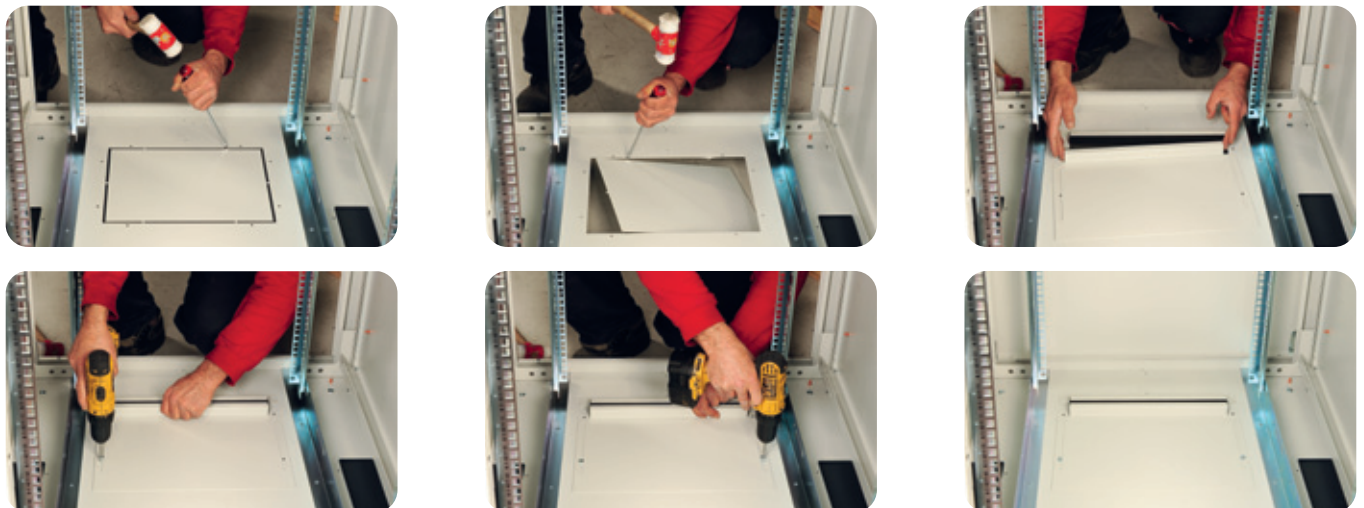

CONSTRUCTION DETAILS:

Access to enclosure:

Front door is integrated with decorative metal housing and full length smoked, shatterproof, antistatic, 4,0mm thickness glass with single point locking handled lock.

Front doors have decorative PVC Stripes charming the attraction, Anthracite Grey for RAL 7035 Light Grey Cabinets and Light Grey for RAL 9005 Black cabinets.

Front door opening direction is set right to left, but reversible to left to right at site with removing the hinge system. Hinge System is spring loaded easy operating version, which allows you to remove the whole front door from cabinet in seconds. No need of any tool during installation or removal of front door.

Front doors have 235degree opening angle, which allows easy access to enclosure, while installation or afterwards the maintenance processes.



Front Door Structure

Rear Doors are lockable and removable with barrel style lock, Multifolded bending technology with 8 fold bending provides the rigidity. Rear doors are with spring loaded hinge system can be removed in seconds from enclosure.

No need of any tools while installing or removing the rear door.

Rear doors have 120degree opening angle



Single Point Handle Lock Details



Rear Door Structure

CONSTRUCTION DETAILS:

Side Panels are lockable and removable with barrel style lock and 2pcs PVC snap lockers per side panel, Multifolded bending technology applied with 8 fold bending provides the rigidity. Easy mechanical locking of panel to main frame with snap capture system allows easy attachment of panels and easy removal in seconds while installation in process. No need of any tools while installing or removing the side panels.

19" rails of Lande CK-Line Series Free Standing cabinets are with automated silk-screen U numbering, depends on size 1U to 42U, same from top to bottom or bottom to top results to same U height selection. No matter from where you have started counting. 19" rails are 4 fold bending surfaces, 1,5mm thickness provides the high load capacities. The 19" rails are made of steel with 8-12 micron zinc plating for corrosion resistance. 19" rails are adjustable in depth. For easy adjustment purpose, no need to detach the screws, just ease the screws and slide them in the channels on the top/bottom chassis bends.

Side Horizontal Support Bar in depth; up to 26U the 19" rails are fixed to just to and bottom case. Higher than 26U the cabinets are integrated with 1 set (left/right) , 1,5mm thickness Z type made of Steel + 8-12 micron zinc plated **side horizontal support bar**

All design features provide 4 way access to your enclosure and equipments, easy to reach to enclosure and equipments for all infrastructure installations and maintenance needs.

CK-Line Cabinets has a decorative ABS header unit. For volume orders or projects, please coordinate with sales department to select any other color application than Anthracite Grey or Black standard offer by Lande.

In standard, all Header Unit upper left corner fitted with a Digital Thermometer with 1 meter cable probe, integrated with 2 lithium battery with 2 year life, measurement once for every minute.



Width=600mm
Depth=600mm

Load Capacity: 600 kgs.

Standard Heights:

8 different U heights: 12U, 16U, 20U, 22U, 26U,32U, 36U, 42U

Standards and Compliances:



ISO 9001:2008
Quality Management System

EN 61587 -1:2012
Mechanical Structures for Electronic Equipment

IEC 297-1, 19" mounting
IEC 297-2 Overall cabinet dimensions



CE conform to
EN 60950-1:2006
Information Technology
Equipment – Safety – Part-1-
General Requirements



Environment Friendly;
* ISO 14001 Environmental
Management System
* RoHS compliancy
* % 100 Recyclable Material



CK-Line Free Standing Cabinets, with 19" w:600mm and d:600mm physical sizes, with max internal usable depth, and 8 different height, gives a wide selection chart for users.

Standard Colors:

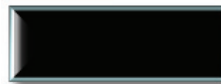

RAL 9005 Black

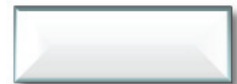

RAL 7035 Light Grey

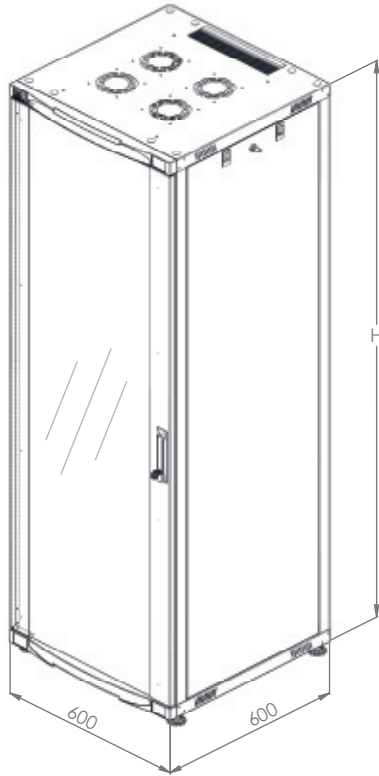

FRONT VIEW

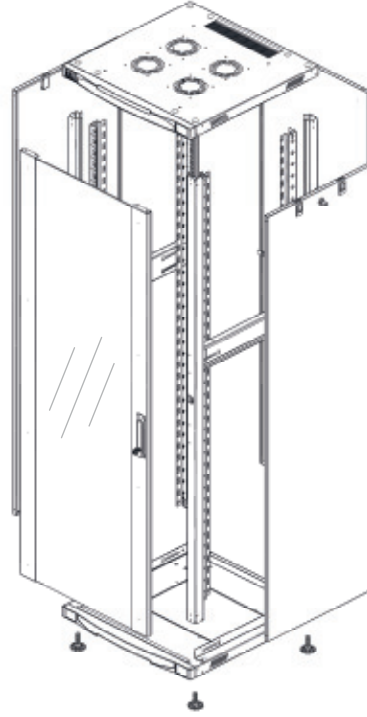

EXPLODED VIEW

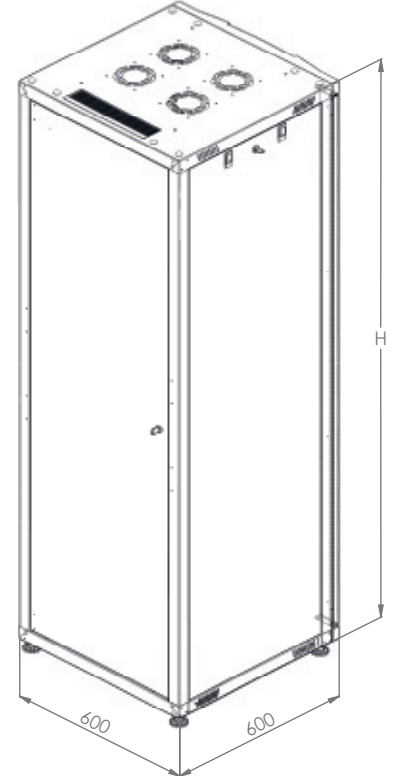

REAR VIEW

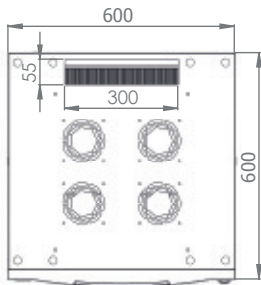

TOP VIEW

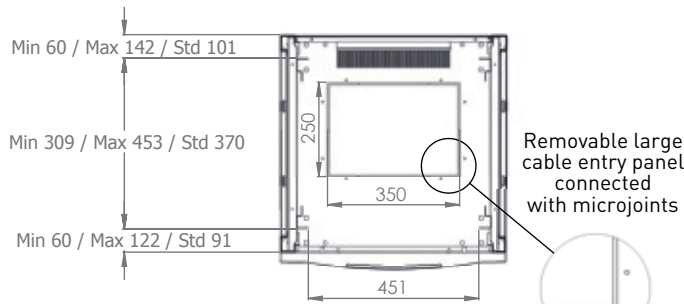

MAX/MIN/STD EQUIPMENT MOUNTING DISTANCE

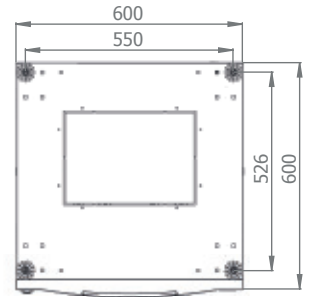

BOTTOM VIEW

CK-Line Free Standing 19" Cabinets W=600mm D=600mm

Part Number	Product Model	Product Description	Size WXDxHmm	Packed Dimensions WXDxHmm	Weight Kgs
LN-CK12U6060-CC	CK MODEL	12U 19" Free Standing Cabinets W=600mm D=600mm with LCD thermometer	600x600x647	680x680x783	26
LN-CK16U6060-CC	CK MODEL	16U 19" Free Standing Cabinets W=600mm D=600mm with LCD thermometer	600x600x824	680x680x960	33
LN-CK20U6060-CC	CK MODEL	20U 19" Free Standing Cabinets W=600mm D=600mm with LCD thermometer	600x600x1002	680x680x1140	40
LN-CK22U6060-CC	CK MODEL	22U 19" Free Standing Cabinets W=600mm D=600mm with LCD thermometer	600x600x1091	680x680x1226	43,5
LN-CK26U6060-CC	CK MODEL	26U 19" Free Standing Cabinets W=600mm D=600mm with LCD thermometer	600x600x1269	680x680x1406	51,5
LN-CK32U6060-CC	CK MODEL	32U 19" Free Standing Cabinets W=600mm D=600mm with LCD thermometer	600x600x1536	680x680x1676	62
LN-CK36U6060-CC	CK MODEL	36U 19" Free Standing Cabinets W=600mm D=600mm with LCD thermometer	600x600x1713	680x680x1854	69,5
LN-CK42U6060-CC	CK MODEL	42U 19" Free Standing Cabinets W=600mm D=600mm with LCD thermometer	600x600x1980	680x680x2120	79

** CC= Color Code, LG Light Grey RAL 7035, BL Black RAL 9005, customers to define while ordering, Product is with Glass Front door with Handled Lock, Rear Solid Metal Hinged Door style with "O" type Barrel Lock.

Width=600mm
Depth=800mm

Load Capacity: 600 kgs.

Standard Heights:

8 different U heights: 12U, 16U, 20U, 22U, 26U, 32U, 36U, 42U

Standards and Compliances:



ISO 9001:2008
Quality Management System

EN 61587 -1:2012
Mechanical Structures for Electronic Equipment

IEC 297-1, 19'' mounting
IEC 297-2 Overall cabinet dimensions



CE conform to
EN 60950-1:2006
Information Technology
Equipment – Safety – Part-1-
General Requirements



Environment Friendly;
* ISO 14001 Environmental
Management System
* RoHS compliancy
* % 100 Recyclable Material



CK-Line Free Standing Cabinets, with 19'' w:600mm and d:800mm physical sizes, with max internal usable depth, and 8 different height, gives a wide selection chart for users.

Standard Colors:

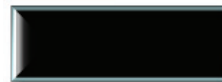

RAL 9005 Black

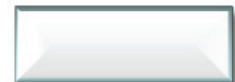

RAL 7035 Light Grey

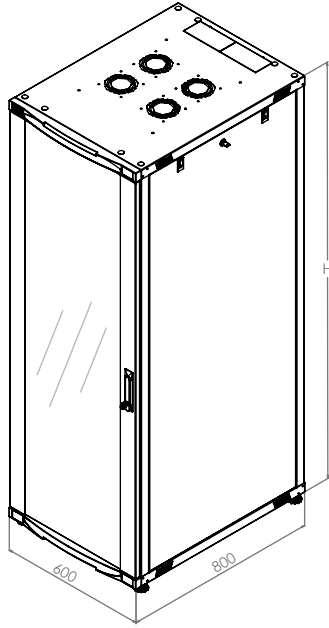

FRONT VIEW

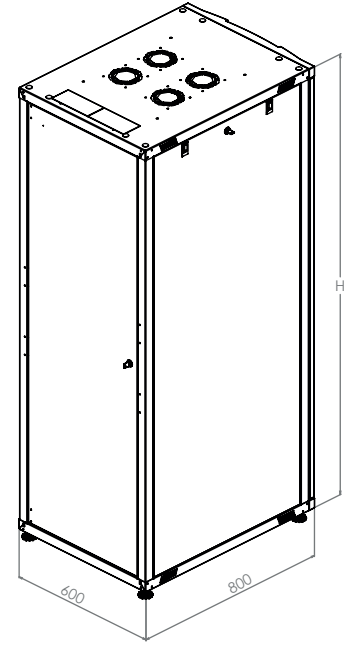

REAR VIEW

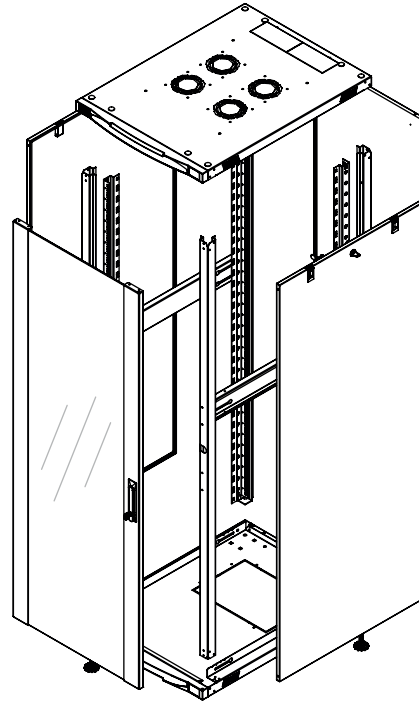

EXPLODED VIEW

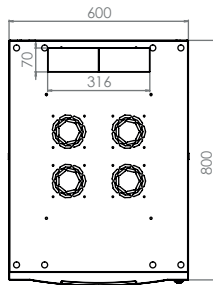

TOP VIEW

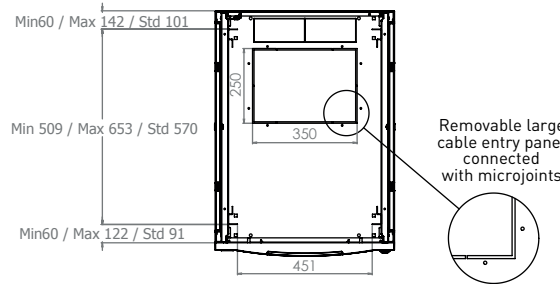

MAX/MIN/STD EQUIPMENT MOUNTING DISTANCE

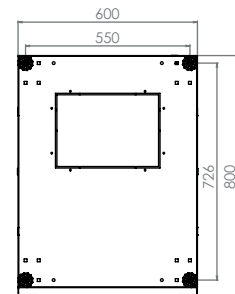

BOTTOM VIEW

CK-Line Free Standing 19" Cabinets W=600mm D=800mm

Part Number	Product Model	Product Description	Size WXDxHmm	Packed Dimensions WXDxHmm	Weight Kgs
LN-CK12U6080-CC	CK-Line	12U 19" Free Standing Cabinets W=600mm D=800mm with LCD thermometer	600x800x647	680x880x783	30
LN-CK16U6080-CC	CK-Line	16U 19" Free Standing Cabinets W=600mm D=800mm with LCD thermometer	600x800x824	680x880x960	38
LN-CK20U6080-CC	CK-Line	20U 19" Free Standing Cabinets W=600mm D=800mm with LCD thermometer	600x800x1002	680x880x1140	45,5
LN-CK22U6080-CC	CK-Line	22U 19" Free Standing Cabinets W=600mm D=800mm with LCD thermometer	600x800x1091	680x880x1226	50
LN-CK26U6080-CC	CK-Line	26U 19" Free Standing Cabinets W=600mm D=800mm with LCD thermometer	600x800x1269	680x880x1406	58,5
LN-CK32U6080-CC	CK-Line	32U 19" Free Standing Cabinets W=600mm D=800mm with LCD thermometer	600x800x1536	680x880x1676	70
LN-CK36U6080-CC	CK-Line	36U 19" Free Standing Cabinets W=600mm D=800mm with LCD thermometer	600x800x1713	680x880x1854	76
LN-CK42U6080-CC	CK-Line	42U 19" Free Standing Cabinets W=600mm D=800mm with LCD thermometer	600x800x1980	680x880x2120	89

** CC= Color Code, LG Light Grey RAL 7035, BL Black RAL 9005, customers to define while ordering, Product is with Glass Front door with Handled Lock, Rear Solid Metal Hinged Door style with "O" type Barrel Lock.

Width=600mm
Depth=1000mm

Load Capacity: 600 kgs.

Standard Heights:

5 different U heights: 22U, 26U, 32U, 36U, 42U

Standards and Compliances:



ISO 9001:2008
Quality Management System

EN 61587 -1:2012
Mechanical Structures for Electronic Equipment

IEC 297-1, 19" mounting
IEC 297-2 Overall cabinet dimensions



CE conform to
EN 60950-1:2006
Information Technology
Equipment – Safety – Part-1-
General Requirements



Environment Friendly;
* ISO 14001 Environmental
Management System
* RoHS compliancy
* % 100 Recyclable Material



CK-Line Free Standing Cabinets, with 19" w:600mm and d:1000mm physical sizes, with max internal usable depth, and 5 different height, gives a wide selection chart for users.

Standard Colors:

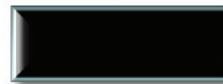

RAL 9005 Black

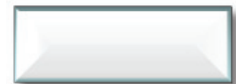

RAL 7035 Light Grey

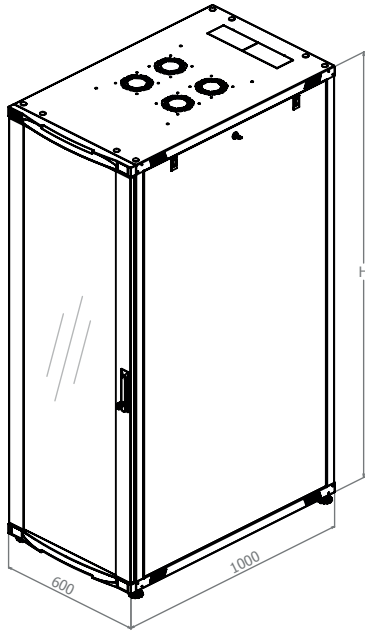

FRONT VIEW

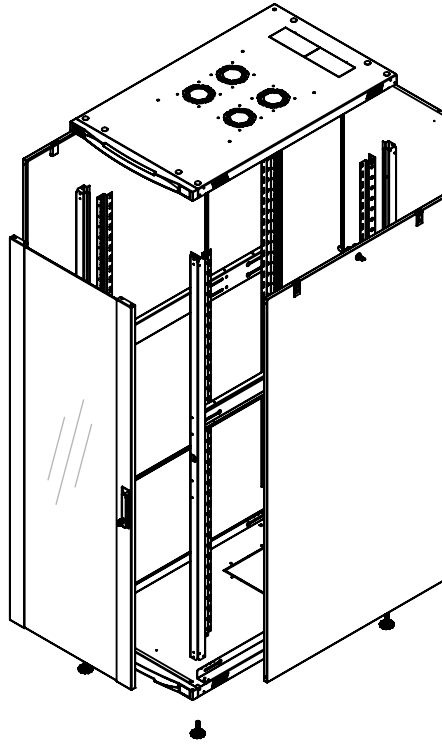

EXPLODED VIEW

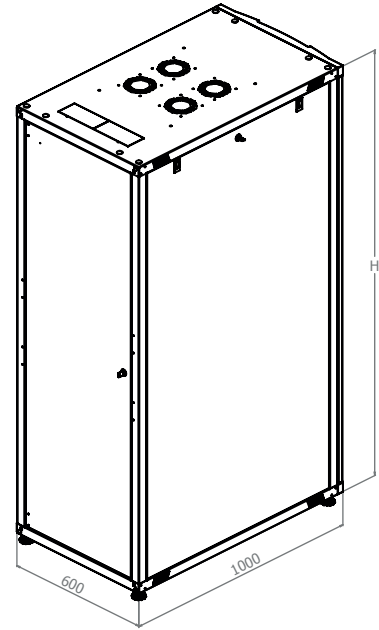

REAR VIEW

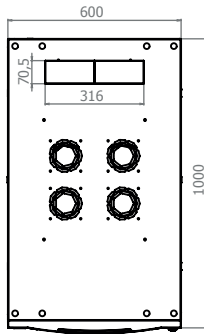

TOP VIEW

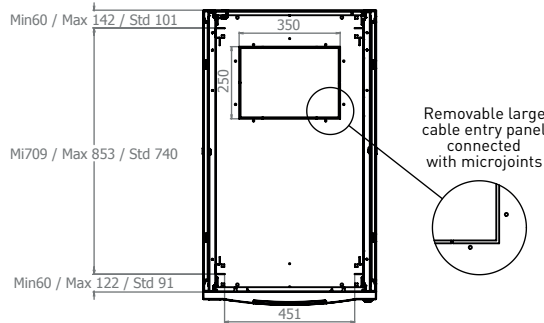

MAX/MIN/STD EQUIPMENT MOUNTING DISTANCE

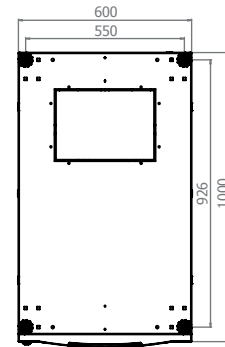

BOTTOM VIEW

CK-Line Free Standing 19" Cabinets W=600mm D=1000mm

Part Number	Product Model	Product Description	Size WXDxHmm	Packed Dimensions WXDxHmm	Weight Kgs
LN-CK22U6010-CC	CK-Line	22U 19" Free Standing Cabinets W=600mm D=1000mm with LCD thermometer	600x1000x1091	680X1080x1226	62
LN-CK26U6010-CC	CK-Line	26U 19" Free Standing Cabinets W=600mm D=1000mm with LCD thermometer	600x1000x1269	680X1080x1406	71
LN-CK32U6010-CC	CK-Line	32U 19" Free Standing Cabinets W=600mm D=1000mm with LCD thermometer	600x1000x1536	680X1080x1676	86
LN-CK36U6010-CC	CK-Line	36U 19" Free Standing Cabinets W=600mm D=1000mm with LCD thermometer	600x1000x1713	680X1080x1854	95
LN-CK42U6010-CC	CK-Line	42U 19" Free Standing Cabinets W=600mm D=1000mm with LCD thermometer	600x1000x1980	680X1080x2120	110

** CC= Color Code, LG Light Grey RAL 7035, BL Black RAL 9005, customers to define while ordering, Product is with Glass Front door with Handled Lock, Rear Solid Metal Hinged Door style with "O" type Barrel Lock

W=800mm CK-Line Free Standing Cabinets are carrying the same constructional features of W=600mm segment with additional features for mass cabling infrastructure needs.

CK-Line Networking Enclosures, provide maximum optimization resulted to an optimum performance in between quality and added value.

While product gives maximum performance on cabling and networking infrastructure, in parallel provides a very valuable economy compared to its quality which is based on high technologic fully automated industry.

The 800 series is available in 32U ,36U and 42U heights for D=800mm, and 42U height for D=1000mm. Each cabinet is supplied in standard with double opening glass front door, single piece steel rear hinged door, all of which are lockable.

CK-Line have a professional technical but aesthetic look with decorative Housing on the front door; the product range attracts the attention with the mostly environmentally fit and selected color of RAL 9005 Black, and RAL 7035 Light Grey, with fine wrinkle soft touch paint.

The product range allows with 1000mm depth versions, usage in private / low density server and storage applications.

Completely standard and stocked product portfolio, being delivered a single piece assembled product, as shipping configuration the adjustable feet group is included.

CK-Line product range with optimal panel mounting size, and a variety range of accesorries enclose the whole expectation of users.

W800xD800mm



W800xD1000mm



CONSTRUCTION DETAILS:

Main Profile- Framework- Top/Bottom Cases:

Multi Folded Automated Bending technology applied corner profile system, provides a heavy duty structure results to high load capacity of: 600 kgs.

Monoblock multi folded top and bottom cases, tightly fixed to the framework with fixing hardware rivets.

Top case has a ready Forced Ventilation (Fan Module) integration housing.

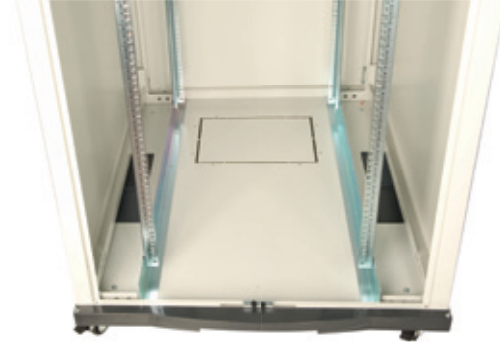
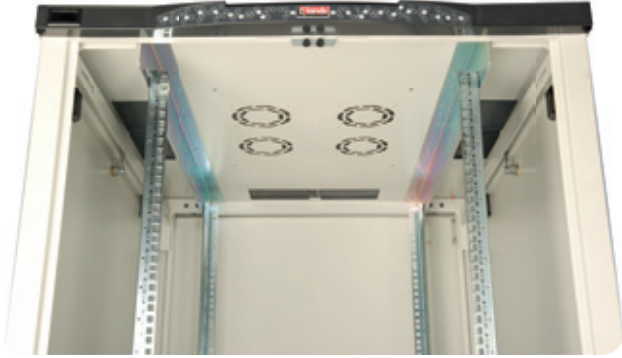

W800mm cabinets these dummy cover plates are located at both left and right side of the roof and bottom case. Also at rear partition of the top case. Once needed, any of these 2pcs Dummy Plates can be removed, to insert the cables from requested partition of either bottom case or top case, even both, in order to allow higher density cable insertion to the enclosure.

As accessory a brush set is offered as 300x55mm size , whenever the cable entry required to be with a protection for the falling dust, this accessory can be used. See accessory section for request.



Bottom case integrated with a large knock-out plate, once cables to come from bottom easily removed and cables to insert. Once a better protection for cables, as well for dust entry, the knock-out provision can be integrated with the rubber edged sliding mechanism on the cable entry point at bottom with w=350mmxd=250mm.

On rubber edged sliding mechanism max cable entry opening is w=350xd=150mm.

After inserting the cables, the rubber edged mechanism holds and fixes the cables in parallel preventing the cabinet from dust entry.

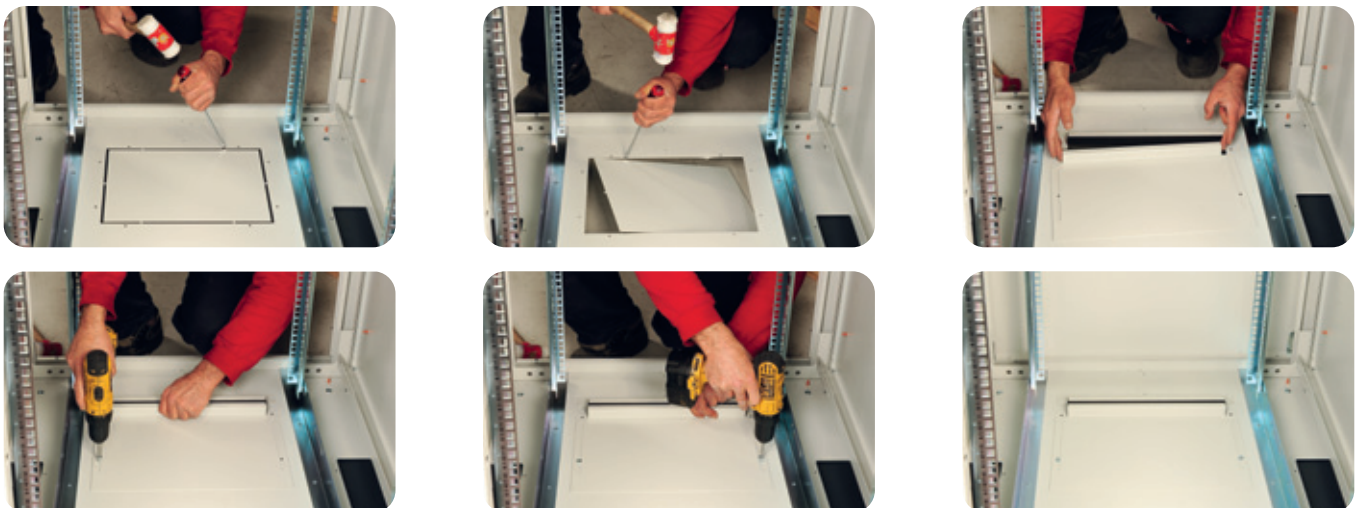

CONSTRUCTION DETAILS:

Access to enclosure:

Front door set is integrated with decorative metal housing and full length smoked, shatterproof, antistatic, 4,0mm thickness glass top/bottom barrel locking system.

Front doors have decorative PVC Stripes charming the attraction, Anthracite Grey for RAL 7035 Light Grey Cabinets and Light Grey for RAL 9005 Black cabinets

Front door is double opening as left and right partition. This allows less clearance in front of the cabinet while front doors are opening. Hinge System is spring loaded easy operating version, which allows you to remove the whole front door from cabinet in seconds. No need of any tool during installation or removal of front door.

Front doors have 235degree opening angle, which allows easy access to enclosure, while installation or afterwards the maintenance processes.



Front Door Structure

Rear Doors are lockable and removable with barrel style lock, Multifolded bending technology with 8 fold bending provides the rigidity. Rear doors are with spring loaded hinge system can be removed in seconds from enclosure.

No need of any tools while installing or removing the rear door.

Rear doors have 120degree opening angle.



Barrel lock on top, with PVC Handle



Barrel lock on bottom, with PVC Handle



Rear Door Structure

CONSTRUCTION DETAILS:

Side Panels are lockable and removable with barrel style lock and 2pcs PVC snap lockers per side panel, Multifolded bending technology applied with 8 fold bending provides the rigidity. Easy mechanical locking of panel to main frame with snap capture system allows easy attachment of panels and easy removal in seconds while installation in process. No need of any tools while installing or removing the side panels.

19" rails of Lande CK-Line Series Free Standing cabinets are with automated silk-screen U numbering, depends on size 1U to 42U, same from top to bottom or bottom to top results to same U height selection. No matter from where you have started counting. 19" rails are 4 fold bending surfaces, 1,5mm thickness provides the high load capacities. The 19" rails are made of steel with 8-12 micron zinc plating for corrosion resistance. 19" rails are adjustable in depth. For easy adjustment purpose, no need to detach the screws, just ease the screws and slide them in the channels on the top/bottom chassis bends.

Side Horizontal Support Bars in depth; W800mm cabinets are integrated with 1 set (left/right) , 1,5mm thickness Omega shape Steel Bar + 8-12 micron zinc plated , and also connection to top and bottom case via L shaped + 8-12 micron zinc plated side horizontal support bars

All design features provide 4 way access to your enclosure and equipments, easy to reach to enclosure and equipments for all infrastructure installations and maintenance needs.

CK-Line Cabinets has a decorative ABS header unit. For volume orders or projects, please coordinate with sales department to select any other color application than Anthracite Grey or Black standard offer by Lande.

In standard, all Header Unit upper left corner fitted with a Digital Thermometer with 1 meter cable probe, integrated with 2 lithium battery with 2 year life, measurement once for every minute.

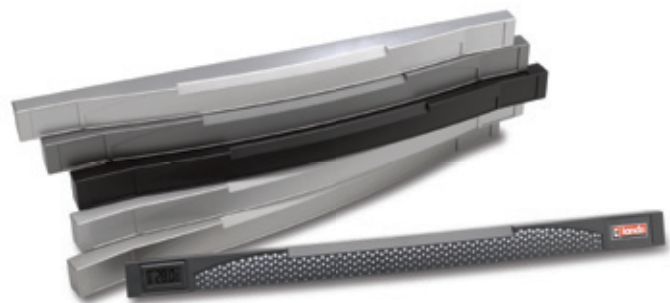

Accessories;

Vertical Cable Managers;

For Mass cabling needs, and for patchcord and cables to be managed in a better way , CK-Line W800mm cabinets are compatible with a set of (Left/Right) Metal Vertical Cable Management 97mmx97mm as per the height of Rack. (32U,36U,42U)

These Vertical cable managers are offered as accessory.

Vertical Cable managers are providing visually a clean and technically professional cabling work, where the main cable bundles are housed and hidden in the vertical cable manager trunks

Marking and Labeling the cables and its bundles are easier, also with Velcro stripes, some separation of cable bundles could be performed, thats why it would be easier to reach to the marked cable or its bundle.

CK-Line Series w:800mm Segment product range with a Digital Thermometer with 1 meter cable probe, integrated with 2 lithium battery with 2 year life, measurement once for every minute.



Vertical Cable Manager

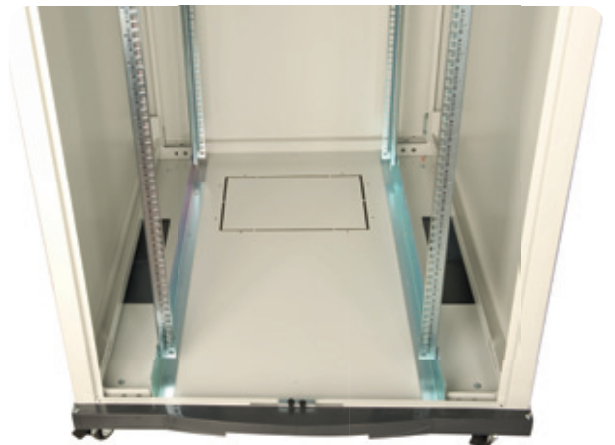

Width=800mm
Depth=800mm

Load Capacity: 600 kgs.

Standard Heights:

3 different U heights: 32U, 36U, 42U

Standards and Compliances:



ISO 9001:2008
Quality Management System

EN 61587 -1:2012
Mechanical Structures for Electronic Equipment

IEC 297-1, 19" mounting
IEC 297-2 Overall cabinet dimensions



CE conform to
EN 60950-1:2006
Information Technology
Equipment – Safety – Part-1-
General Requirements



Environment Friendly;
* ISO 14001 Environmental
Management System
* RoHS compliancy
* % 100 Recyclable Material



CK-Line Free Standing Cabinets, with 19" w:800mm and d:800mm physical sizes, with max internal usable depth, and 3 different height, gives a wide selection chart for users.

Standard Colors:

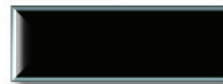

RAL 9005 Black

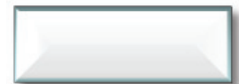

RAL 7035 Light Grey

19" CK-Line Free Standing Cabinets
Width:800mm depth:800mm General Construction

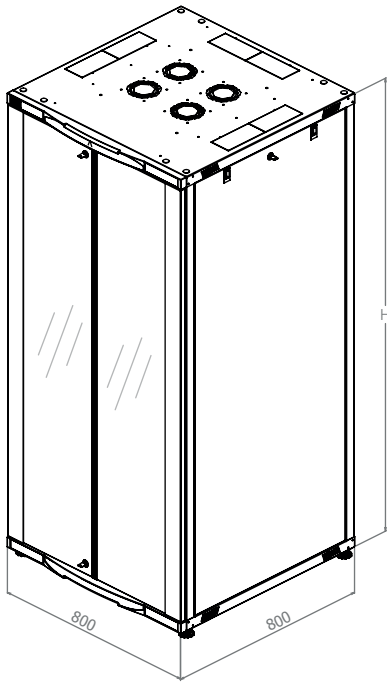

FRONT VIEW

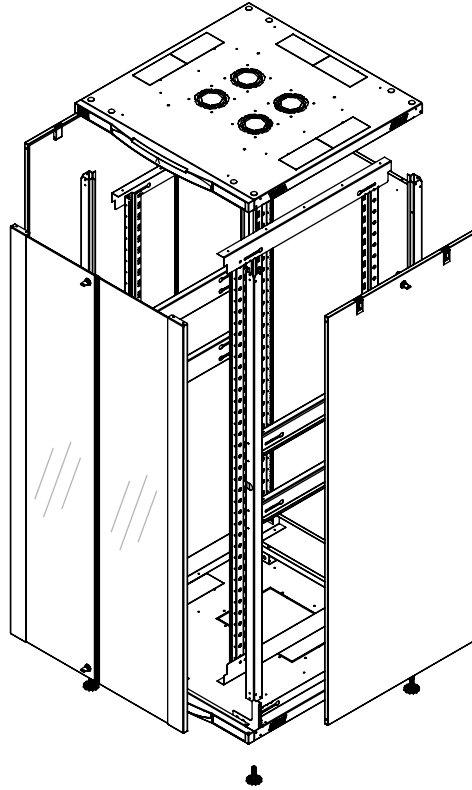

EXPLODED VIEW

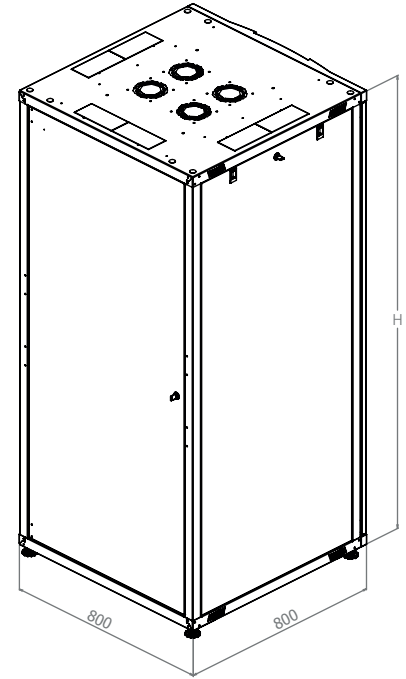

REAR VIEW

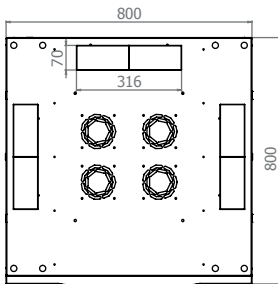

TOP VIEW

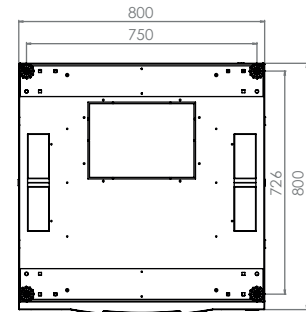

BOTTOM VIEW

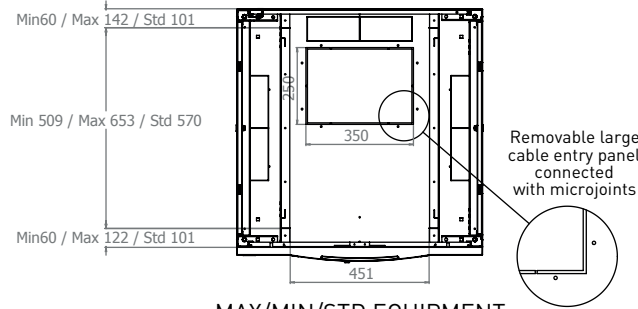

MAX/MIN/STD EQUIPMENT MOUNTING DISTANCE

Removable large cable entry panel connected with microjoints

CK-Line Free Standing 19" Cabinets W=800mm D=800mm

Part Number	Product Model	Product Description	Size WXDxHmm	Packed Dimensions WXDxHmm	Weight Kgs
LN-CK32U8080-CC	CK-Line	32U 19" Free Standing Cabinets W=800mm D=800mm with LCD thermometer	800x800x1536	880x880x1676	90
LN-CK36U8080-CC	CK-Line	36U 19" Free Standing Cabinets W=800mm D=800mm with LCD thermometer	800x800x1713	880x880x1854	101
LN-CK42U8080-CC	CK-Line	42U 19" Free Standing Cabinets W=800mm D=800mm with LCD thermometer	800x800x1980	880x880x2120	118
LN-KDG-ORG-32EU-CC	ACCESSORY	32U METAL Cable Management panel set left/right	97x97x1440	130X190X1450	7
LN-KDG-ORG-36EU-CC	ACCESSORY	36U METAL Cable Management panel set left/right	97x97x1620	130X190X1650	8
LN-KDG-ORG-42EU-CC	ACCESSORY	42U METAL Cable Management panel set left/right	97x97x1885	130X190X1950	10

** CC= Color Code, LG Light Grey RAL 7035, BL Black RAL 9005, customers to define while ordering, Product is with Glass Front door with Handled Lock, Rear Solid Metal Hinged Door style with "O" type Barrel Lock

Width=800mm
Depth=1000mm

Load Capacity: 600 kgs.

Standard Heights:

U height: 42U

Standards and Compliances:



ISO 9001:2008
Quality Management System

EN 61587 -1:2012
Mechanical Structures for Electronic Equipment

IEC 297-1, 19" mounting
IEC 297-2 Overall cabinet dimensions



CE conform to
EN 60950-1:2006
Information Technology
Equipment – Safety – Part-1-
General Requirements



Environment Friendly;
* ISO 14001 Environmental
Management System
* RoHS compliancy
* % 100 Recyclable Material



CK-Line Free Standing Cabinets, with 19" w:800mm and d:1000mm physical size, with max internal usable depth, and 42U available height offered in standard

Standard Colors:

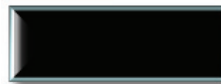

RAL 9005 Black

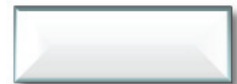

RAL 7035 Light Grey

19" CK-Line Free Standing Cabinets
Width:800mm depth:1000mm General Construction

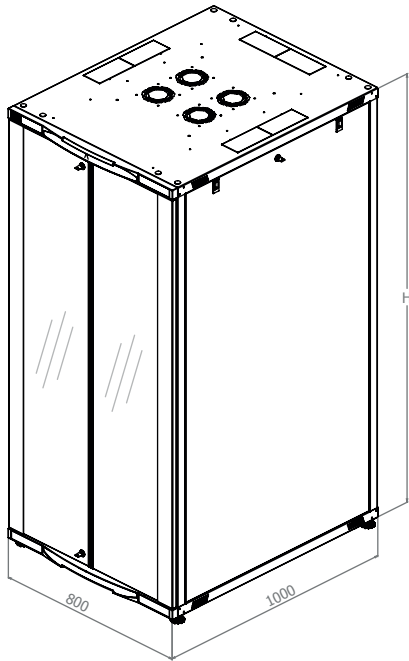

FRONT VIEW

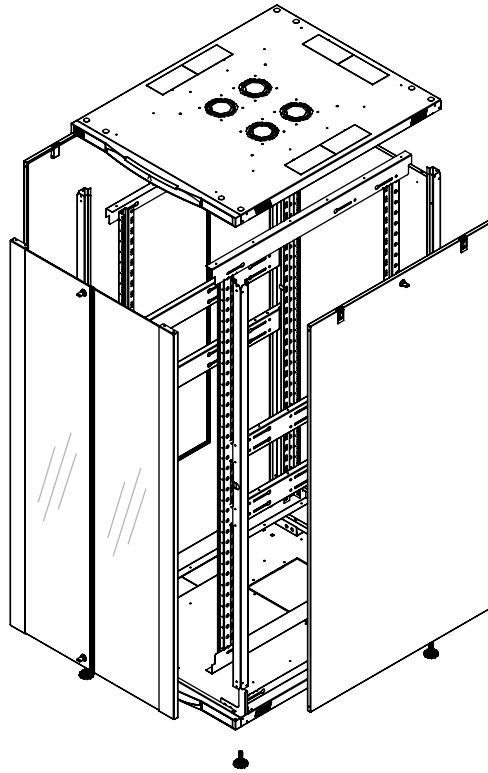

EXPLODED VIEW

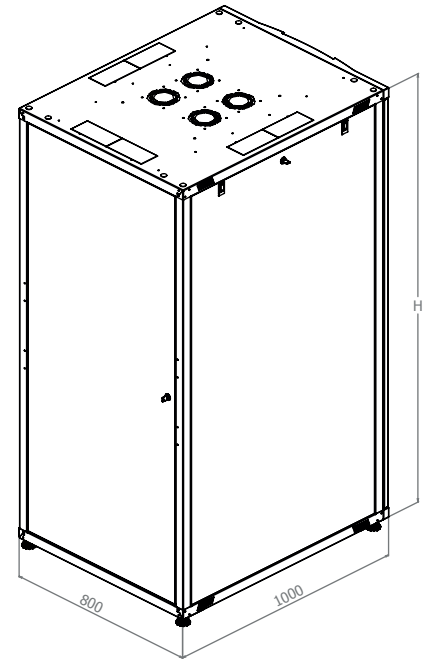

REAR VIEW

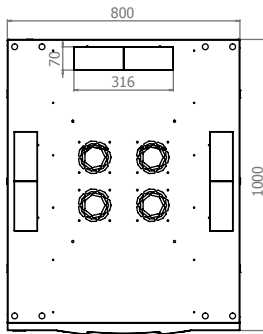

TOP VIEW

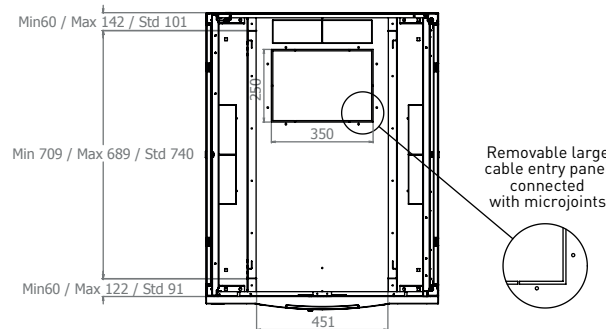

MAX/MIN/STD EQUIPMENT MOUNTING DISTANCE

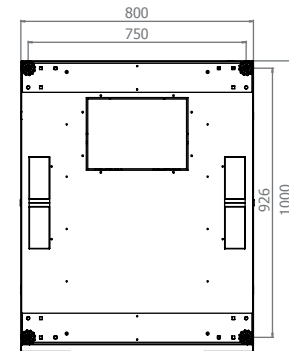

BOTTOM VIEW

CK-Line Free Standing 19" Cabinets W=800mm D=800mm

Part Number	Product Model	Product Description	Size WXDxHmm	Packed Dimentions WXDxHmm	Weight Kgs
LN-CK42U8010-CC	CK-Line	42U 19" Free Standing Cabinets W=800mm D=1000mm with LCD thermometer	800x1000x1980	880x1080x2120	134
LN-KDG-ORG-42EU-CC	ACCESSORY	42U METAL Cable Management panel set left/right	97x97x1885	130X190X1950	10

** CC= Color Code, LG Light Grey RAL 7035, BL Black RAL 9005, customers to define while ordering, Product is %63 perforated Handled Locking Solid Metal Single Opening Front and Rear door

W=600mm D=1000mm and W=600mm D=1000mm CK-Line Server Cabinets

CK-Line Server cabinets are carrying the same constructional features, additionally carrying a better environment for the server and storage equipments within the perforated front and rear doors.

CK-Line Server Cabinets, provide maximum optimization resulted to an optimum performance in between quality and added value.

While product gives maximum performance on servering and storage infrastructure, in parallel provides a very valuable economy compared to its quality which is based on high technologic fully automated industry.

The 600 series is available in 5 heights, as 22U,26U,32U,36U and 42U, with 1000mm depth.

Each cabinet is supplied as standard with a %63 perforated single piece monoblock front and rear door, and lift off steel side panels, all of which are lockable.

CK-Line Server Cabinets have a professional technical but aesthetic look with decorative %63 perforated honey comb pattern. The product range attracts the attention with the mostly environmentally fit and selected color of RAL 9005 Black, and RAL 7035 Light Grey, with fine wrinkle soft touch paint.

The product range is for with 1000mm depth versions, usage in private / low density server and storage applications.

Completely standard and stocked product portfolio, being delivered a single piece assembled product, as shipping configuration the adjustable feet group is included.

CK-Line server product range with optimal panel mounting size, and a variety range of accesories enclose the whole expectation of users.

W600xD1000mm



W800xD1000mm



Width=600mm
Depth=1000mm

Load Capacity: 600 kgs.

Standard Heights:

5 different U heights: 22U, 26U, 32U, 36U, 42U

Standards and Compliances:



ISO 9001:2008
Quality Management System

EN 61587 -1:2012
Mechanical Structures for Electronic Equipment

IEC 297-1, 19" mounting
IEC 297-2 Overall cabinet dimensions



CE conform to
EN 60950-1:2006
Information Technology
Equipment – Safety – Part-1-
General Requirements



Environment Friendly;
* ISO 14001 Environmental
Management System
* RoHS compliancy
* % 100 Recyclable Material



CK-Line Server Cabinets, with 19" w:600mm and d:1000mm physical sizes, with max internal usable depth, and 5 different height, gives a wide selection chart for users.

Standard Colors:

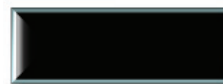

RAL 9005 Black



RAL 7035 Light Grey

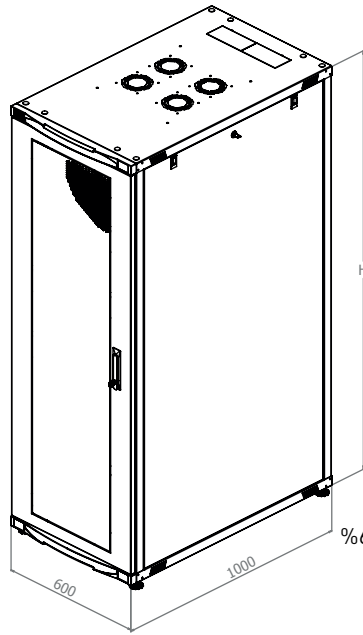

FRONT VIEW

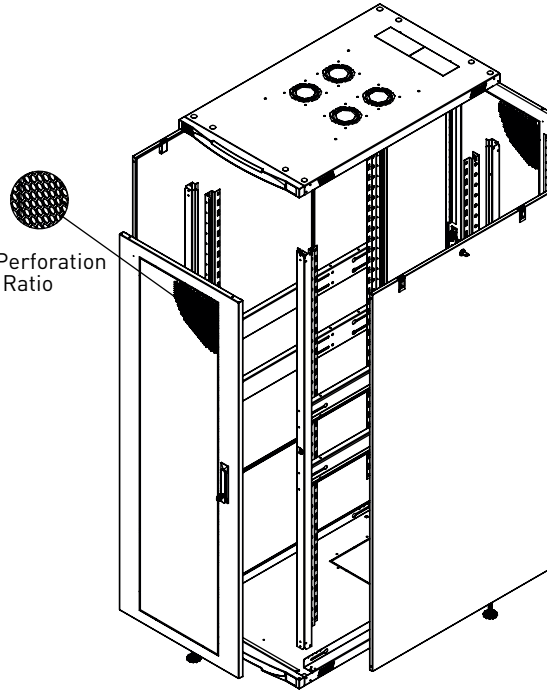

EXPLODED VIEW

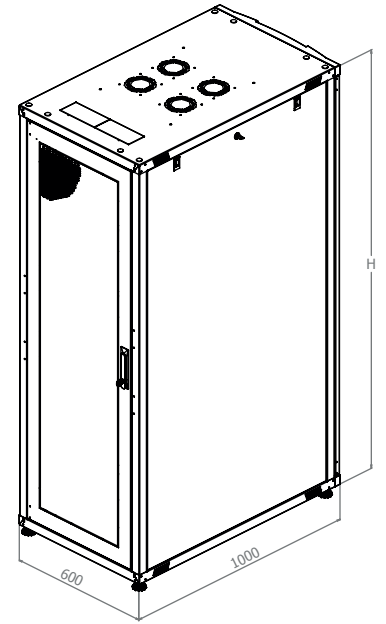

REAR VIEW

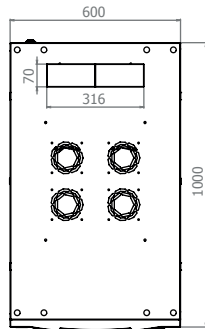

TOP VIEW

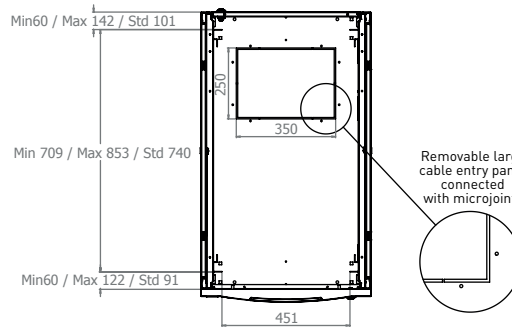

MAX/MIN/STD EQUIPMENT MOUNTING DISTANCE

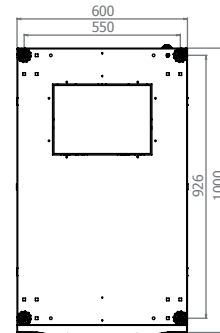

BOTTOM VIEW

CS MODEL Free Standing SERVER 19" Cabinets W=600mm D=1000mm (Perforated doors)

Part Number	Product Model	Product Description	Size WXDxHmm	Packed Dimentions WXDxHmm	Weight Kgs
LN-CS22U6010-CC	CK-Line Server	22U 19" Free Standing Cabinets W=600mm D=1000mm with LCD thermometer	600x1000x1091	680x1080x2505	62
LN-CS26U6010-CC	CK-Line Server	26U 19" Free Standing Cabinets W=600mm D=1000mm with LCD thermometer	600x1000x1269	680x1080x1455	71
LN-CS32U6010-CC	CK-Line Server	32U 19" Free Standing Cabinets W=600mm D=1000mm with LCD thermometer	600x1000x1536	680x1080x1720	86
LN-CS36U6010-CC	CK-Line Server	36U 19" Free Standing Cabinets W=600mm D=1000mm with LCD thermometer	600x1000x1713	680x1080x1900	96
LN-CS42U6010-CC	CK-Line Server	42U 19" Free Standing Cabinets W=600mm D=1000mm with LCD thermometer	600x1000x1980	680x1080x2160	112

** CC= Color Code, LG Light Grey RAL 7035, BL Black RAL 9005, customers to define while ordering, Product is %63 perforated Handled Locking Solid Metal Single Opening Front and Rear door

Width=800mm
Depth=1000mm

Load Capacity: 600 kgs.

Standard Heights:

U height: 42U

Standards and Compliances:



ISO 9001:2008
Quality Management System

EN 61587 -1:2012
Mechanical Structures for Electronic Equipment

IEC 297-1, 19" mounting
IEC 297-2 Overall cabinet dimensions



CE conform to
EN 60950-1:2006
Information Technology
Equipment – Safety – Part-1-
General Requirements



Environment Friendly;
* ISO 14001 Environmental
Management System
* RoHS compliancy
* % 100 Recyclable Material



CK-Line Server Cabinet, with 19" w:800mm and d:1000mm physical size, with max internal usable depth and 42U available height offered in standard

Standard Colors:

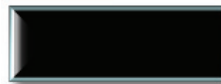

RAL 9005 Black

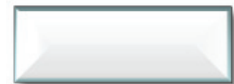

RAL 7035 Light Grey

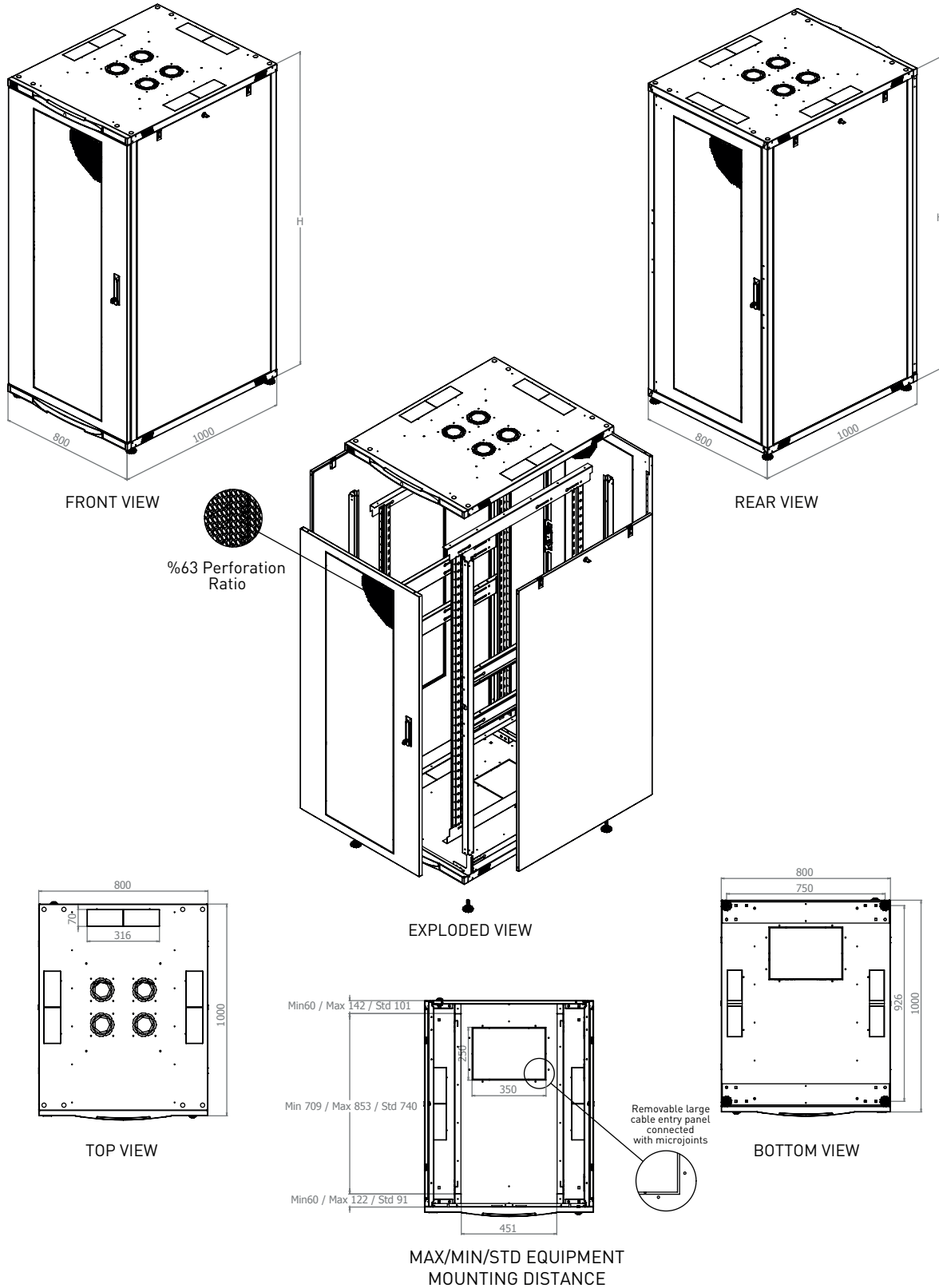

CS MODEL Free Standing SERVER 19" Cabinets W=800mm D=1000mm (Perforated doors)

Part Number	Product Model	Product Description	Size WXDxHmm	Packed Dimentions WXDxHmm	Weight Kgs
LN-CS42U8010-CC	CK-Line Server	42U 19" Free Standing Cabinets W=800mm D=1000mm with LCD thermometer	800x1000x1980	880x1080x2120	142
LN-KDG-ORG-42EU-CC	ACCESSORY	42U METAL Cable Management panel set left/right	97x97x1885	130X190X1950	10

** CC= Color Code, LG Light Grey RAL 7035, BL Black RAL 9005, customers to define while ordering, Product is %63 perforated Handled Locking Solid Metal Single Opening Front and Rear door.

ACCESSORIES



Castor Set with Support Bar

Castor Group, with support Bar				
Part Number	Product Model	Product Description	Packed Dimentionions WXDXHmm	Weight Kgs
LN-ZMN-TKR-5525-CK-W6	ACCESSORY	Castor Group, with W600mm 2 Metal Support Bracket, 4 pcs castor, 2 with brake, 2 without brake	610X110X100	3,5
LN-ZMN-TKR-5525-CK-W8	ACCESSORY	Castor Group, with W800mm 2 Metal Support Bracket, 4 pcs castor, 2 with brake, 2 without brake	810X110X100	4,5

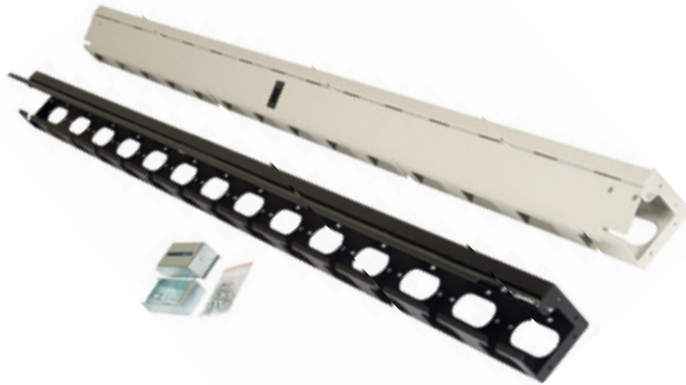

Vertical Cable Managers

Vertical Cable Managers					
Part Number	Product Model	Product Description	Size WXDXHmm	Packed Dimentionions WXDXHmm	Weight Kgs
LN-KDG-ORG-32EU-CC	ACCESSORY	32U METAL Cable Management panel set left/right	97x97x1440	130X190X1450	8
LN-KDG-ORG-36EU-CC	ACCESSORY	36U METAL Cable Management panel set left/right	97x97x1620	130X190X1650	10
LN-KDG-ORG-42EU-CC	ACCESSORY	42U METAL Cable Management panel set left/right	97x97x1885	130X190X1950	12

** CC= Color Code, LG Light Grey RAL 7035, BL Black RAL 9005

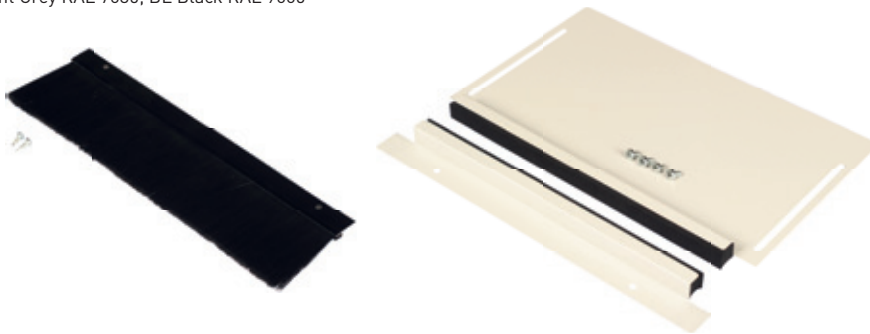

Cable Entry Modules

Cable Entry Module Rubber Edged Sliding Mechanism and Brush				
Part Number	Product Model	Product Description	Packed Dimentionions WXDXHmm	Weight Kgs
LN-DGR-CME-CC	ACCESSORY	Sliding Cable Entry Panel, with Rubber Edged Mechanism	350x400x20	1
LN-DGR-CMB-BL	ACCESSORY	Brushed Cable Entry Panel	60x500x15	0,1

* All CK-Line cabinets are supplied with knock-out micro joint bottom cable entry plate, incase needed an accessory as cable entry module rubber edged with sliding mechanism can be ordered- LN-DGR-CME-CC

** CK-Line cabinets are supplied with Plastic Dummy Panels on the Cable Entry Point, incase needed an accessory as cable entry brushes can be ordered, LN-DGR-DMB-BL

*** CC= Color Code, LG Light Grey RAL 7035, BL Black RAL 9005, customers to define while ordering



HEAD OFFICE

Safa Mah. Atatürk Cad. Yağız Sok. No:4
Yenidoğan - Sancaktepe - İstanbul / TURKEY

Tel : +90 216 312 2653 pbx

Fax: +90 216 312 0909

FACTORY

20. Cadde No: 14 Eskişehir Organize Sanayi
Bölgesi 26110 Eskişehir / TURKEY

Tel: +90 222 236 2466 pbx

Fax: +90 222 236 1353

